

# Xonar Essence One

## Hi-Fi USB DAC (Digital-to-Analog Converter)

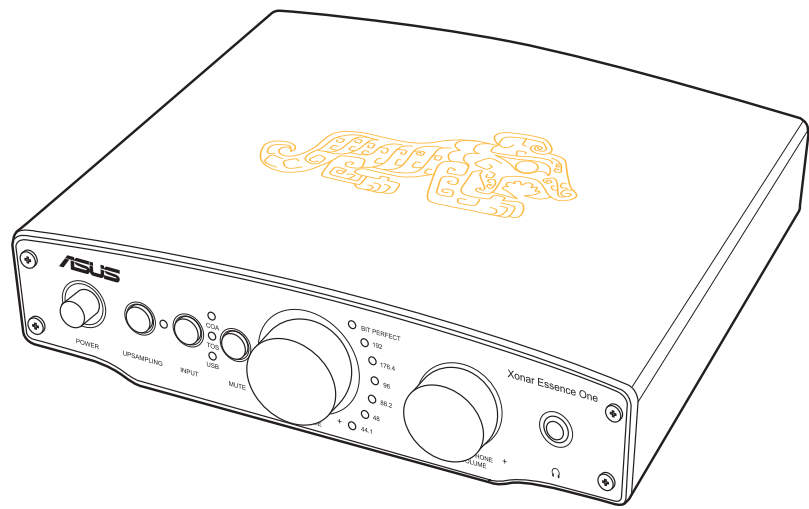

## Quick Start Guide

## Safety Information

- Read and keep these instructions for future reference.
- Follow all instructions and take note of all warnings.
- Do not use this apparatus near water or expose the device to moisture.
- Clean machine surface with a cloth. Avoid using detergent or cleaning fluid.
- Do not block any ventilation openings. Install in accordance with the manufacturer's instructions.
- Do not install near any heat sources such as radiators, heat registers, stoves, or other apparatus (including amplifiers) that produce heat.
- The polarized or grounding-type plug is for user safety. A polarized plug has two blades with one wider than the other. A grounding type plug has two blades and a third grounding prong. The wide blade or the third prong is provided for your safety. If the provided plug does not fit into your outlet, consult an electrician for replacement of the outlet.
- Protect the power cord from being stepped on or compressed particularly at the point where it exits from the apparatus.
- Only use attachments/accessories approved by the manufacturer.
- Use only with the cart, stand, tripod, bracket, or table specified by the manufacturer, or sold with the apparatus. When using a cart, take care to avoid tipping over the load when moving the device.
- Unplug this apparatus during lightning storms or when not in use for a long period of time.
- Refer all repairs to qualified service personnel. Servicing is required when the apparatus has been damaged in any way, such as when the power-supply cord or plug is damaged, liquid has been spilled or objects have fallen into the apparatus, the apparatus has been exposed to rain or moisture, does not operate normally, or has been dropped.



## Package Contents

This package should contain the following:

- ASUS Xonar Essence One Hi-Fi USB DAC x 1
- User Manual x 1
- USB cable ('B-A' type) x 1
- Installation driver CD x 1
- Audio Precision (AP) test report x 1
- 6.3mm to 3.5mm adapter x 1
- Power cord x 1 (may contain two power cords depending on region/country)

## System Requirements

To ensure a successful installation of the ASUS Xonar Essence One USB DAC, your computer must meet the following requirements:

- IBM compatible PC with one USB2.0 (or higher) compatible port for the USB audio device
- Microsoft Windows 8 (32/64bit) / 7 / XP (32/64bit) / MCE2005
- Intel Pentium 4 1.4GHz, AMD Athlon 1400 CPU, or faster CPU
- 256 MB DRAM system memory
- 60 MB available HDD space for driver installation
- CD-ROM drive (or DVD-ROM drive) for software installation
- High-quality headphones or powered analog speakers

## Driver Installation

After connecting the ASUS Xonar Essence One to your computer using the bundled USB cable, install the device driver using the provided CD.

### NOTES:

- Driver installation is only required if you plan to connect the ASUS Xonar Essence One to a PC or notebook.
- Driver version and the contents of the support CD are subject to change without notice.

To install the device driver:

- Insert the **ASUS Xonar Essence One Support CD** into your optical drive. Proceed to step 5 if **Autorun** is enabled on your computer and the driver setup screen appears. If Autorun is not enabled on your computer, perform step 2.
- On your Windows desktop, launch **File Explorer**.
  - Windows 7 SP1 Click **Start** then **Computer**.
  - Windows 8 Click **[ ] + E**
- In **File Explorer**, double-click the optical drive icon.
- Double-click **Setup.exe**.
- Read through the **End User License Agreement** and click **Accept** when prompted. Follow the onscreen instructions to complete the driver installation.
- When driver installation is complete, you will be prompted to restart your computer.

## Functionality

### USB DAC (Digital-to-Analog Converter) Stand alone DAC

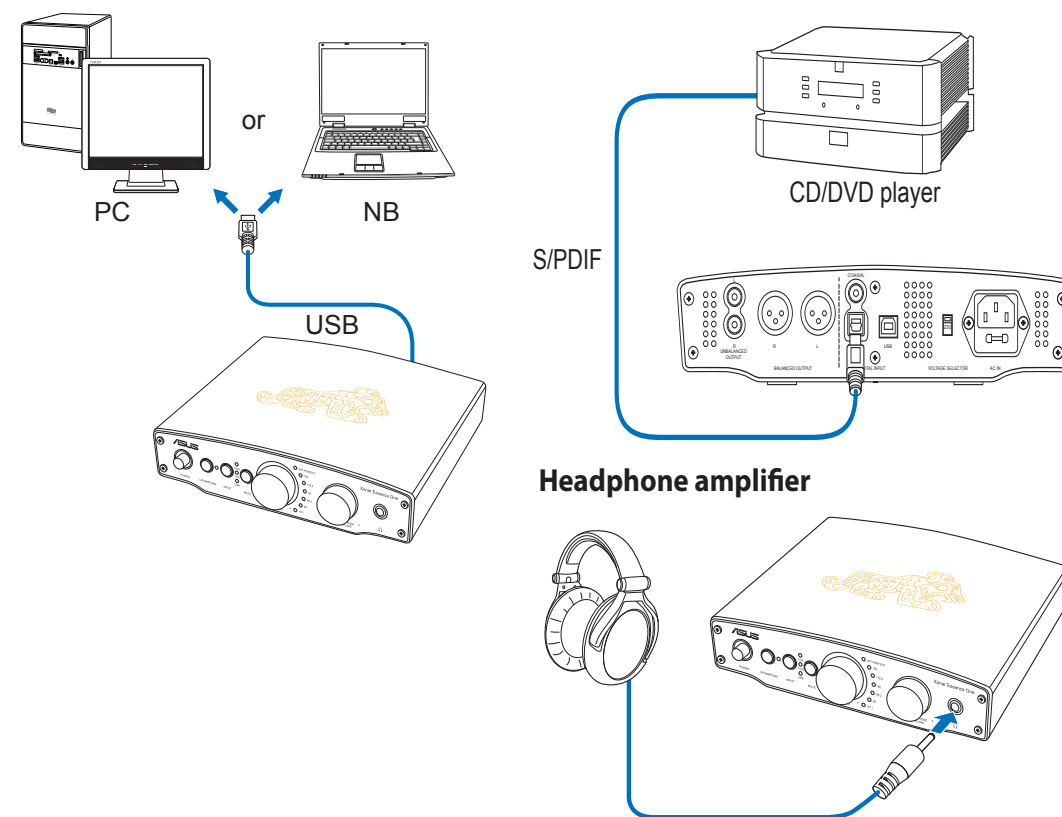

### Headphone amplifier

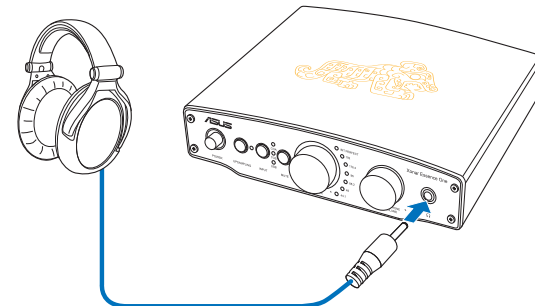

## Hardware Features

### Front panel

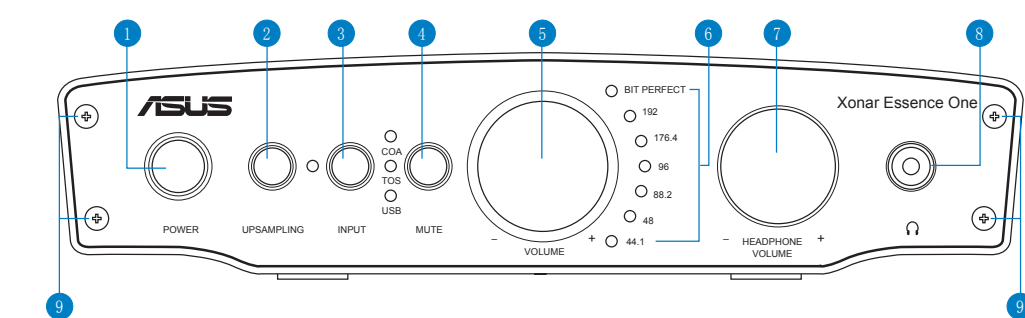

- Power On/Off:** Press to power off/on Xonar Essence One.
- Upsampling function on/off:** (1) Press to turn on the upsampling function which increases sample rate to 352.8 or 384kHz symmetrically and bit rate to 32bit; (2) When the upsampling function is turned on, the LED light of Bit perfect / sample rate indicator will light off.
- Input selection:** Press to select among USB, Toslink or Coaxial Inputs. The corresponding LED will light up to show which source has been selected.
- Mute:** Press to mute headphone and speaker output; again to unmute.
- Speaker volume control:** The Volume Control controls the output level of the balanced XLR and unbalanced RCA analog outputs.
- Bit perfect / Sample Rate Indicator:** (1) The relevant LED will light up to indicate the sample rate of your audio source (44.1kHz, 48 kHz, 88.2 kHz, 96 kHz, 176.4 kHz, and 192 kHz); (2) Bit perfect: light on under ASIO model
- Headphone volume control:** The volume control adjusts the output levels of the headphone jacks.
- 1/4" Headphone output:** Connect your high-quality headphones/headsets with 6.3mm connector (Please use the attached 6.3mm to 3.5mm connector if your headphones/headsets are of 3.5 mm ports)
- Set screws:** These 4 screws are used to hold the machine bed (including PCB board and power module) and machine housing together.

### FRANÇAIS

#### Panneau avant

- Bouton Marche/Arrêt
- Suréchantillonnage
- Sélection d'entrée
- Sourdine
- Contrôle du volume (haut-parleurs)
- Voyant lumineux Bit-perfect / taux d'échantillonnage
- Contrôle du volume (casque)
- Sortie casque 1/4"
- Ensemble de vis

### DEUTSCH

#### Vorderseite

- Ein-/Austaste
- Upsampling-Funktion An/Aus
- Eingangswahl
- Stummschalten
- Lautsprecher-Lautstärkeregl.
- Anzeige für Bit Perfect / Sample Rate (Abtastrate)
- Kopfhörer-Lautstärkeregl.
- 1/4" Kopfhöreranschluss
- Schrauben

### ITALIANO

#### Pannello frontale

- Accensione/spengimento
- Attiva/disattiva la funzione di sovracampionamento
- Selezione input
- Silenziamento
- Controllo volume altoparlanti
- Indicatore Bit perfect / frequenza di campionamento
- Controllo volume cuffie
- Uscita cuffie 1/4"
- Viti

### РУССКИЙ

#### ФРАНЦУЗСКИЙ

- Включение/отключение питания
- Включение/отключение функции upsampling (повышение частоты выборки)
- Выбор входа
- Отключить звук
- Регулятор громкости динамиков
- Bit perfect/индикатор частоты дискретизации
- Регулятор громкости наушников
- 1/4" разъем для наушников
- Винты крепления

### БЪЛГАРСКИ

#### Преден панел

- Вкл./Изкл.
- Вкл./изкл. на увеличаване на честотата на дискретизация
- Избор на вход
- Изключване на звука
- Управление на силата на звука на високоговорителя
- Bit perfect/Индикатор на честотата на дискретизация
- Управление на силата на звука на слушалките
- 1/4"-es fehallgató-kimenet
- Комплект винтове

### HRVATSKI

#### Prednja ploča

- Uključivanje / isključivanje
- Funkcija uzorkovanja uključena/isključena
- Odabir ulaza
- Utišaj
- Regulator glasnoće zvučnika
- Indikator za Bit perfect / brzinu prijenosa
- Regulator glasnoće slušalice
- Utišnica za slušalice ¼ inča
- Komplet vijaka

### ČEŠTINA

#### Přední panel

- Vypínač
- Zapnutí/vypnutí funkce zvýšení vzorkovací frekvence
- Výběr vstupu
- Ztlumit
- Ovladač hlasitosti reproduktorů
- Indikátor Bit-Perfect / vzorkovací frekvence
- Regulator hlasitosti sluchávek
- Ovladač hlasitosti sluchátek
- Výstup pro připojení 1/4" sluchátek
- Sada šroubků

## Hardware Features

### DANSK

#### Forpanel

- Tænd/sluk
- Opsampling-funktion til/fra
- Indgangsvalg
- Lyd fra
- Lydstyrkeknep til højttaler
- Bit perfect / Samplefrekvens-indikator
- Lydstyrkeknep til hovedtelefoner
- 1/4" Hovedtelefonstik
- Skruer

### NEDERLANDS

#### Voorpaneel

- In/uitschakelen
- Functie Upsampling aan/uit
- Ingangsselectie
- Dempen
- Volumeregeling luidspreker
- Indicator bitperfect / bemonsteringsfrequentie
- Volumeregeling hoofdtelefoon
- 1/4" hoofdtelefoonuitgang
- Set schroeven

### SUOMI

#### Etupaneeli

- Virta Päälle/Pois
- Parannustoiminto päälle/pois
- Tulon valinta
- Mykistä
- Kaiuttimien äänenvoimakkuuden säätö
- Bit perfect / Näytenopeus -merkkivalo
- Kuulokkeiden äänenvoimakkuuden säätö
- 1/4" kuulokelähtö
- Aseta ruuvit

### ΕΛΛΗΝΙΚΑ

#### Μπροστινή πλευρά

- Λειτουργία On/Off (Ενεργ./Απενεργ.)
- Ενεργ./Απενεργ. λειτουργίας δειγματοληψίας προς τα πάνω
- Επιλογή εισόδου
- Σίγαση
- Ρύθμιση έντασης ηχείου
- Ένδειξη Bit perfect / Ρυθμός δειγματοληψίας
- Ρύθμιση έντασης ακουστικών
- Έξοδος ακουστικών 1/4"
- Ρύθμιση βιδών

### MAGYAR

#### Eiőlap

- Főkapcsoló
- Felskálázás funkció be/ki
- Bemenetválasztás
- Némítás
- Hangszóró hangerő-szabályozó
- Érintetlen bitátvitel / Mintavételezési sebesség kijelző
- Fejhallgató hangerő-szabályozó
- 1/4"-es fehallgató-kimenet
- Állítócsavarok

### NORSK

#### Frontpanel

- Strøm på/av
- Oppsamplingsfunksjon på/av
- Inngangsvalg
- Demp
- Volumkontroll for høytaler
- Bitperfect / samplingsfrekvensindikator
- Volumkontroll for hodetelefon
- 1/4" hodetelefonutgang
- Innstillingskruser

### POLSKI

#### Panel przedni

- Włączenie/wyłączenie zasilania
- Włącznik/wyłącznik funkcji zwiększenia próbkowania
- Wybór wejścia
- Wyciszenie
- Regulacja głośności głośnika
- Wskaźnik zgodności bitowej/częstotliwości próbkowania
- Regulacja głośności słuchawek
- Wyjście słuchawkowe 1/4 cala
- Wkręty dociskowe

### PORTUGUÊS

#### Painel frontal

- Ligar/Desligar
- Activar/desactivar a função de aumento da frequência de amostragem
- Seleção da entrada
- Cortar o som
- Controlo do volume do altifalante
- Indicador de bit perfect / frequência de amostragem
- Controlo do volume dos auscultadores
- Saída para auscultadores de 1/4"
- Parafusos

### ROMÂNĂ

#### Panoul frontal

- Pornire/Oprire alimentare
- Activarea/Dezactivarea funcției de anulare e eșantionării
- Selectare intrare
- Dezactivare sunet
- Control al volumului pentru difuzoare
- Indicator Bit perfect/rată de eșantionare
- Control al volumului pentru căști
- leşire 1/4" căști
- Şuruburi de fixare

### ESPAÑOL

#### Panel frontal

- Encendido y apagado
- Activar/Desactivar la función de aumento de la tasa de muestreo
- Selección de entrada
- Silencio
- Control de volumen del altavoz
- Indicador de Bit-Perfect y tasa de muestreo
- Control de volumen de los auriculares
- Salida de auriculares de 1/4"
- Tornillos

### SVENSKA

#### Frontpanel

- Ström På/Av
- Uppsamplingsfunktion på/av
- Inmatningsval
- Tysta
- Kontroll högtalarevolym
- Bit perfekt/indikator samplingshastighet
- Kontroll hörlursvolym
- ¼ tum hörlursutmatning
- Uppsättning skruvar

### Rear panel

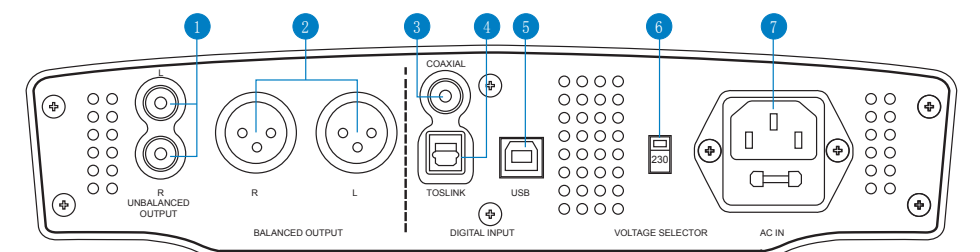

- Unbalanced RCA Output (line-out):** Conventional stereo outputs for connection to the line-level phono/RCA inputs of a speaker
- Balanced XLR Output (line-out):** ASUS Xonar Essence One also features true balanced (XLR) outputs. Connect Xonar Essence One with equipment such as speakers of Balanced XLR connections.
- Coaxial S/PDIF Input:** Connect your digital source, such as CD/DVD players or computer with S/PDIF output, to digital input. Use either S/PDIF coaxial or Toslink optical type, each being of equal quality.
- Toslink Optical Input:** This port is for Toslink Optical Input.
- USB port:** Connect a PC via a Type B to Type A USB lead.
- Voltage selection (115/230V):** Select the appropriate system input voltage according to the voltage supply in your area.
- Power port (AC in):** Plug the supplied power cord into the Xonar Essence One once you have completed all connections.

### FRANÇAIS

#### Panneau arrière

- Sortie RCA dissymétrique (line-out).
- Sortie XLR symétrique (line-out)
- Entrée S/PDIF coaxiale
- Entre Toslink optique
- Port USB
- Sélection du voltage (115/230V)
- Prise d'alimentation (entrée CA)

### DEUTSCH

#### Rückseite

- Unbalancierte RCA-Ausgänge (line-out)
- Balancierte XLR-Ausgänge (line-out)
- Koaxialer S/PDIF-Eingang
- Toslink Optischer Eingang
- USB-Anschluss
- Spannungswähler (115/230V)
- Stromkabelanschluss (AC in)

### SRPSKI

#### Prednji panel

- Uključeno/isključeno napajanje
- Funkcija za učestalost uzorkovanja uključena/isključena
- Odabir unosa
- Utišaj
- Kontrola jačine tona zvučnika
- Bit savršen / Indikator za učestalost uzorkovanja
- Kontrola jačine tona slušalice
- 1/4" ilzaz za slušalice
- Zavrtnji kompleta

### SLOVENŠČINA

#### Sprednja ploča

- Vklop/izklop
- Vklop/izklop funkcije ojačenja vzorčenja
- Izbira vhoda
- Nemo
- Nadzor glasnosti zvočnika
- Bit savršen / Indikator za učestalost vzorčenja
- Nadzor glasnosti slušalk
- 1/4" izhod za slušalke
- Namestitve vijake

### TÜRKÇE

#### Ön panel

- Güç Açık/Kapalı
- Üst örnekleme işlevi açık/kapalı
- Giriş seçimi
- Sessiz
- Hoparlör ses denetimi
- Bit mükemmel / Numune Oranı Göstergesi
- Kulaklık ses denetimi
- 1/4" Kulaklık Çıkışı
- Ayar vidaları

### УКРАЇНСЬКА

#### Передня панель

- Увімкнути/вимкнути живлення
- Увімкнути/вимкнути функцію дискретизації
- Вибір входу
- Без звуку
- Контроль гучності динаміків
- Bit perfect / Індикатор частоти дискретизації
- Контроль гучності навушників
- Вихід гарнітури 1/4"
- Встановити гвинти

### ITALIANO

#### Pannello posteriore

- Uscita RCA non bilanciata (line-out).
- Uscita XLR bilanciata (line-out)
- Ingresso coassiale S/PDIF
- Ingresso ottico Toslink
- Porta USB
- Selezione Voltaggio (115/230V)
- Porta alimentazione (AC in)

### РУССКИЙ

#### Задняя панель

- Несимметричный выход RCA (линейный выход)
- Симметричный выход XLR (линейный выход)
- Коаксиальный S/PDIF-вход
- Оптический вход Toslink
- Порт USB
- Переключатель напряжения (115/230В)
- Разъем питания (перем. ток)



## Hardware Features

### БЪЛГАРСКИ

#### Заден панел

1. Небалансиран RCA изход (Line-Out)
2. Балансиран XLR изход (Line-Out)
3. Коаксиален S/PDIF вход
4. TOSLINK оптичен вход
5. USB порт
6. Избор на напрежението (115/230V)
7. Порт на захранване (DC вход)

### HRVATSKI

#### Straznja ploča

1. Neuravnoteženi RCA izlaz (linijski izlaz)
2. Uravnoteženi XLR izlaz (linijski izlaz)
3. Koaksijalni S/PDIF ulaz
4. TOSLINK optički ulaz
5. USB priključak
6. Odabir napona (115/230 V)
7. Priključak za napajanje (DC ulaz)

### ČEŠTINA

#### Zadní panel

1. Nevyvážený výstup RCA (linkový výstup)
2. Uvážený výstup XLR (linkový výstup)
3. Koaxiální vstup S/PDIF
4. Optický vstup TOSLINK
5. Port USB
6. Výběr napětí (115/230 V)
7. Port napájení (vstup stejnosměrného napájení)

### DANSK

#### Bagpanel

1. Ikke-balanceret RCA-udgang (linje-ud)
2. Balanceret XLR-udgang (linje-ud)
3. Koaksial S/PDIF-indgang
4. TOSLINK optisk indgang
5. USB-port
6. Spændingsvalg (115/230V)
7. Strømport (DC-indgang)

### NEDERLANDS

#### Achterpaneel

1. Niet-gebalanceerde RCA-uitgang (lijnuitgang)
2. Gebalanceerde XLR-uitgang (lijnuitgang)
3. Coaxiale S/PDIF-ingang
4. Optische TOSLINK-ingang
5. USB-poort
6. Spanningsselectie (115/230V)
7. Voedingsaansluiting (DC in)

### SUOMI

#### Takapaneeli

1. Tasapainottamaton RCA-lähtö (Linja ulos)
2. Tasapainotettu XLR-lähtö (Linja ulos)
3. Koaksiaalinen S/PDIF -tulo
4. TOSLINK-optinen tulo
5. USB-portti
6. Jännitevalinta (115/230 V)
7. Virtaportti (Tasavirtatulo)

### ΕΛΛΗΝΙΚΑ

#### Πίσω πλευρά

1. Μη εξισορροπημένη έξοδος RCA (Γραμμική έξοδος)
2. Εξισορροπημένη έξοδος XLR (Γραμμική έξοδος)
3. Ομοαξονική είσοδος S/PDIF
4. Οπτική είσοδος TOSLINK
5. Θύρα USB
6. Επιλογή τάσης (115/230V)
7. Θύρα ισχύος (είσοδος DC)

### MAGYAR

#### Hátlap

1. Aszimmetrikus RCA kimenet (Vonalszintű kimenet)
2. Szimmetrikus XLR kimenet (Vonalszintű kimenet)
3. Koaxiális S/PDIF bemenet
4. TOSLINK optikai bemenet
5. USB-port
6. Feszültségválasztó (115/230V)
7. Tápfeszültség bemeneti aljzat (DC bemenet)

### PORTUGUÊS

#### Painel traseiro

1. Saída RCA desequilibrada (saída de linha)
2. Saída XLR equilibrada (saída de linha)
3. Entrada S/PDIF coaxial
4. Entrada óptica Toslink
5. Porta USB
6. Seleção de tensão (115/230V)
7. Porta de alimentação (entrada AC)

### NORSK

#### Bakpanelet

1. Ubalansert RCA-utgang (linje ut)
2. Balansert XLR-utgang (linje ut)
3. Koaksial S/PDIF-inngang
4. TOSLINK optisk inngang
5. USB-port
6. Spenningsvalg (115/230 V)
7. Strømkontakt (likestrøm inn)

### POLSKI

#### Panel tylny

1. Niezbalansowane wyjście RCA (wyjście liniowe)
2. Zbalansowane wyjście XLR (wyjście liniowe)
3. Wejście koncentryczne S/PDIF
4. Wejście optyczne Toslink
5. Port USB
6. Przelącznik napięcia (115/230 V)
7. Port zasilania (wejście AC)

### ROMÂNĂ

#### Panoul din spate

1. Ieşire RCA dezechilibrată (ieşire linie)
2. Ieşire XLR echilibrată (ieşire linie)
3. Intrare coaxială S/PDIF
4. Intrare optică TOSLINK
5. Port USB
6. Selectare tensiune (115/230V)
7. Port alimentare (intrare c.c.)

### SRPSKI

#### Zadnji panel

1. Nebalansiran RCA izlaz (Izlazna linija)
2. Balansiran XLR izlaz (Izlazna linija)
3. Koaksijalni S/PDIF ulaz
4. TOSLINK optički ulaz
5. USB port
6. Odabir napona (115/230V)
7. Priključak za napajanje (DC ulaz)

### SLOVENŠČINA

#### Zadnja plošča

1. Uravnotežen izhod RCA (»line-out«)
2. Uravnotežen izhod XLR (»line-out«)
3. Koaksijalni vhod S/PDIF
4. Optični vhod TOSLINK
5. Vrata USB
6. Izbira napetosti (115/230V)
7. Vrata za napajanje (vhodna enosm. napetost)

### ESPAÑOL

#### Panel posterior

1. Salida RCA no balanceada (salida de línea)
2. Salida XLR balanceada (salida de línea)
3. Entrada S/PDIF coaxial
4. Entrada óptica Toslink
5. Puerto USB
6. Selección de voltaje (115/230 V)
7. Conector de alimentación (entrada de CA)

### SVENSKA

#### Bakre panel

1. Obalanserad RCA utmatning (Line-Out)
2. Balanserad XLR utmatning (Line-Out)
3. Koaxial S/PDIF inmatning
4. TOSLINK optisk inmatning
5. USB-port
6. Spänningsval (115/230 V)
7. Strömport (DC in)

### TÜRKÇE

#### Arka panel

1. Dengelenmemiş RCA Çıkışı (çıkış)
2. Dengeli XLR Çıkışı (Hat Çıkışı)
3. Koaksiyel S/PDIF Girişi
4. Toslink Optik Girişi
5. USB bağlantı noktası
6. Gerilim seçme (115/230V)
7. Güç bağlantı noktası (DC girişi)

### УКРАЇНСЬКА

#### Задня панель

1. Незбалансований вихід RCA (Вихід лінії)
2. Збалансований вихід XLR (Вихід лінії)
3. Коаксіальний вхід S/PDIF
4. Оптичний вхід TOSLINK
5. Порт USB
6. Вибір напруги (115 / 230 В)
7. Порт живлення (вхід постійного струму)

## Connectivity Options

### Connecting a desktop PC or notebook PC

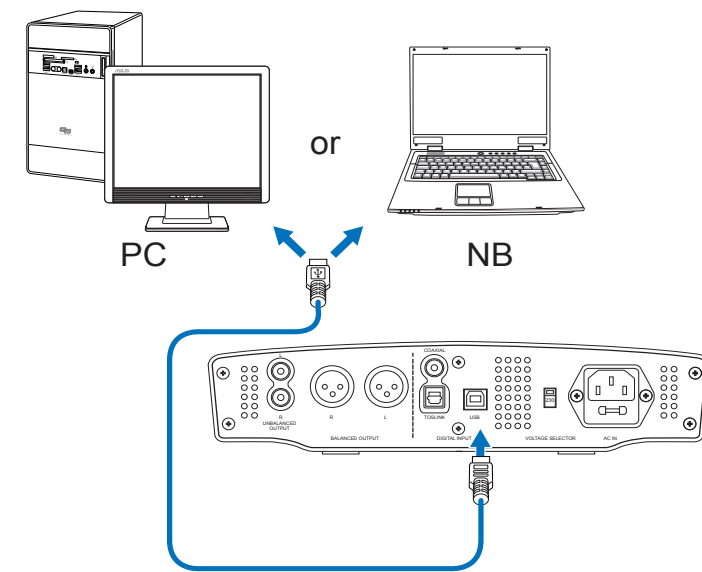

1. Connect a USB B-A type cable to the Xonar Essence One's rear USB port to a USB port on your desktop PC or notebook PC.
2. Power on the Xonar Essence One and select USB input using the front panel. Ensure that the USB LED is on.
3. Install the device driver from the support CD.

### Toslink and Coaxial S/PDIF audio input

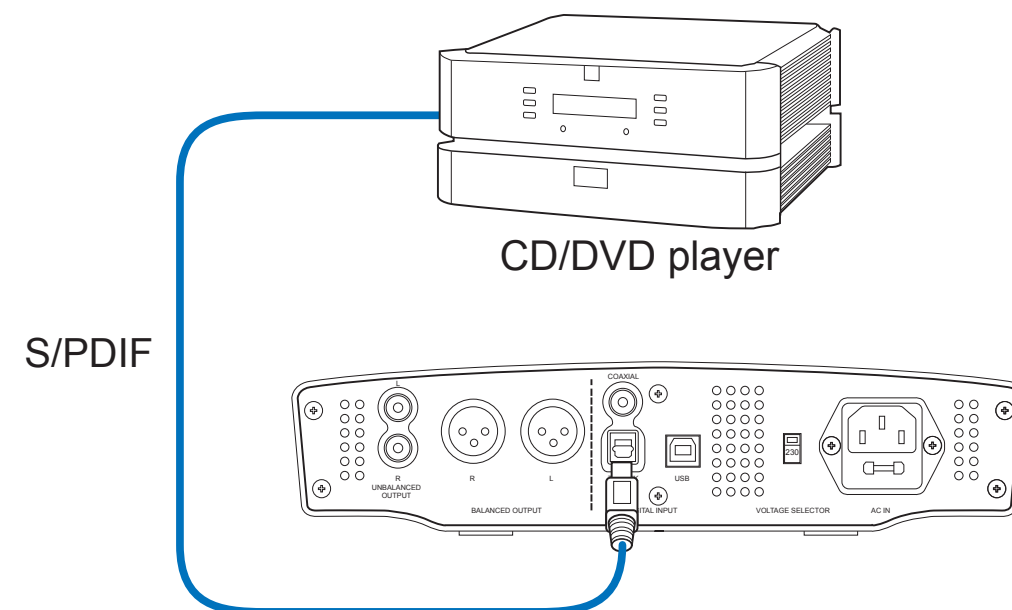

### With Amplifier and Passive Speaker System

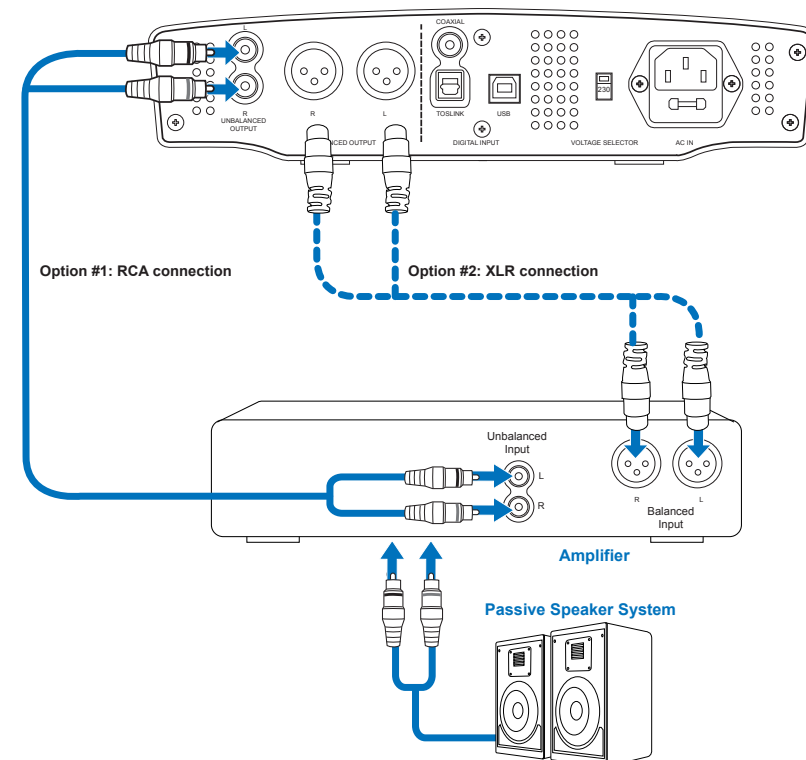

### With Active Speaker directly

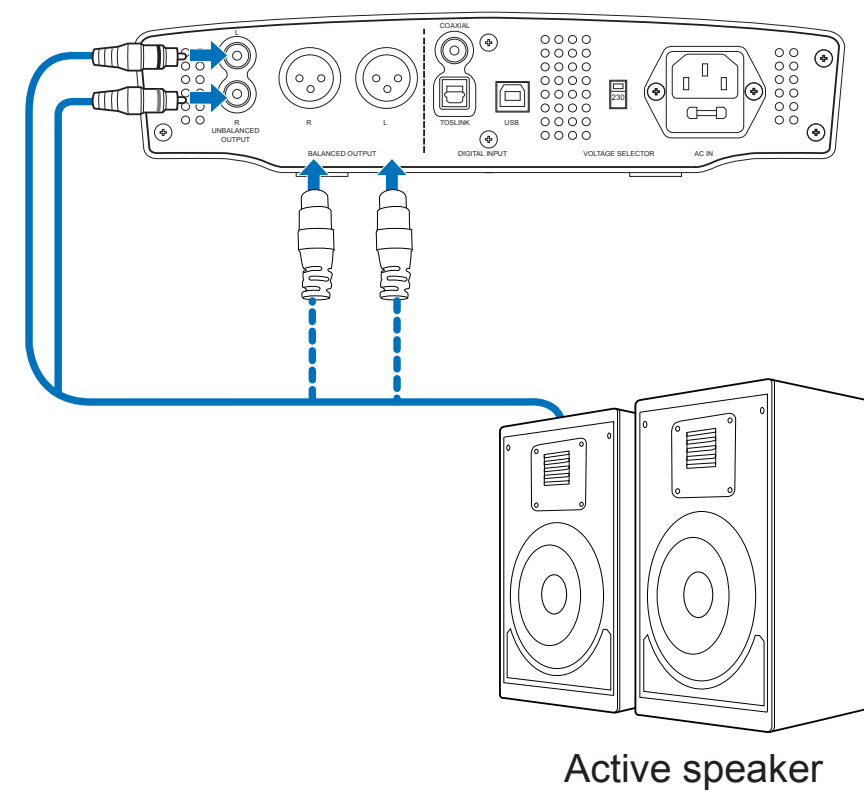

### With Headphone/Headset

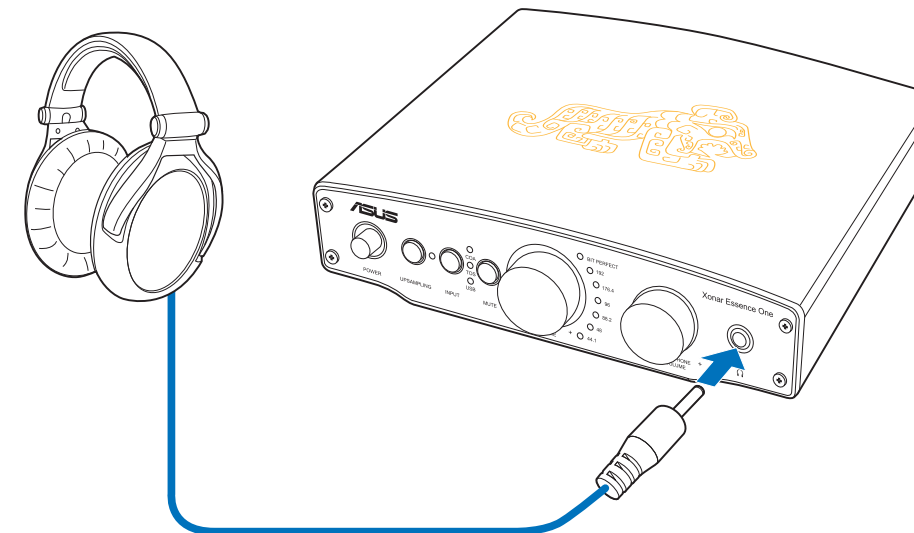

**ASUS**  
Inspiring Innovation • Persistent Perfection

## ASUS WARRANTY UPDATE

From 1 January 2012 updated warranties apply to all ASUS products, consistent with the Australian Consumer Law.

For the latest product warranty details please visit: <http://support.asus.com>

Our goods come with guarantees that cannot be excluded under the Australian Consumer Law. You are entitled to a replacement or refund for a major failure and compensation for any other reasonably foreseeable loss or damage. You are also entitled to have the goods repaired or replaced if the goods fail to be of acceptable quality and the failure does not amount to a major failure.

If you require assistance please call ASUS Customer Service 1300 2787 88 | <http://support.asus.com>