



MDS-M700 Series

AI-ready Medical Computer

User Manual

E23170
First Edition
April 2024

COPYRIGHT INFORMATION

No part of this manual, including the products and software described in it, may be reproduced, transmitted, transcribed, stored in a retrieval system, or translated into any language in any form or by any means, except documentation kept by the purchaser for backup purposes, without the express written permission of ASUSTeK COMPUTER INC. ("ASUS").

ASUS PROVIDES THIS MANUAL "AS IS" WITHOUT WARRANTY OF ANY KIND, EITHER EXPRESS OR IMPLIED, INCLUDING BUT NOT LIMITED TO THE IMPLIED WARRANTIES OR CONDITIONS OF MERCHANTABILITY OR FITNESS FOR A PARTICULAR PURPOSE. IN NO EVENT SHALL ASUS, ITS DIRECTORS, OFFICERS, EMPLOYEES OR AGENTS BE LIABLE FOR ANY INDIRECT, SPECIAL, INCIDENTAL, OR CONSEQUENTIAL DAMAGES (INCLUDING DAMAGES FOR LOSS OF PROFITS, LOSS OF BUSINESS, LOSS OF USE OR DATA, INTERRUPTION OF BUSINESS AND THE LIKE), EVEN IF ASUS HAS BEEN ADVISED OF THE POSSIBILITY OF SUCH DAMAGES ARISING FROM ANY DEFECT OR ERROR IN THIS MANUAL OR PRODUCT.

Products and corporate names appearing in this manual may or may not be registered trademarks or copyrights of their respective companies, and are used only for identification or explanation and to the owners' benefit, without intent to infringe.

SPECIFICATIONS AND INFORMATION CONTAINED IN THIS MANUAL ARE FURNISHED FOR INFORMATIONAL USE ONLY, AND ARE SUBJECT TO CHANGE AT ANY TIME WITHOUT NOTICE, AND SHOULD NOT BE CONSTRUED AS A COMMITMENT BY ASUS. ASUS ASSUMES NO RESPONSIBILITY OR LIABILITY FOR ANY ERRORS OR INACCURACIES THAT MAY APPEAR IN THIS MANUAL, INCLUDING THE PRODUCTS AND SOFTWARE DESCRIBED IN IT.

Copyright © 2024 ASUSTeK COMPUTER INC. All Rights Reserved.

LIMITATION OF LIABILITY

Circumstances may arise where because of a default on ASUS' part or other liability, you are entitled to recover damages from ASUS. In each such instance, regardless of the basis on which you are entitled to claim damages from ASUS, ASUS is liable for no more than damages for bodily injury (including death) and damage to real property and tangible personal property; or any other actual and direct damages resulted from omission or failure of performing legal duties under this Warranty Statement, up to the listed contract price of each product.

ASUS will only be responsible for or indemnify you for loss, damages or claims based in contract, tort or infringement under this Warranty Statement.

This limit also applies to ASUS' suppliers and its reseller. It is the maximum for which ASUS, its suppliers, and your reseller are collectively responsible.

UNDER NO CIRCUMSTANCES IS ASUS LIABLE FOR ANY OF THE FOLLOWING: (1) THIRD-PARTY CLAIMS AGAINST YOU FOR DAMAGES; (2) LOSS OF, OR DAMAGE TO, YOUR RECORDS OR DATA; OR (3) SPECIAL, INCIDENTAL, OR INDIRECT DAMAGES OR FOR ANY ECONOMIC CONSEQUENTIAL DAMAGES (INCLUDING LOST PROFITS OR SAVINGS), EVEN IF ASUS, ITS SUPPLIERS OR YOUR RESELLER IS INFORMED OF THEIR POSSIBILITY.

SERVICE AND SUPPORT

Visit our multi-language website at <https://www.asus.com/support/>

Contents

About this manual.....	5
Conventions used in this manual.....	6
Package contents	7

Chapter 1: Getting to know your Medical Computer

1.1 Features	10
1.1.1 Front view	10
1.1.2 Rear view.....	11
1.1.3 Left view	16
1.1.4 Right view	16

Chapter 2: Using your Medical Computer

2.1 Getting started	18
2.1.1 Connect the power cord to your Medical Computer.....	18
2.1.2 Connect a display panel to your Medical Computer.....	21
2.1.3 Connect the USB cable from keyboard or mouse	22
2.1.4 Turn on your Medical Computer	23
2.2 Turning off your Medical Computer.....	24

Appendix

Safety instructions.....	26
Regulatory notices	33
Service and Support	43

About this manual

This manual provides information about the hardware and software features of your Medical Computer, organized through the following chapters:

Chapter 1: Getting to know your Medical Computer

This chapter details the hardware components of your Medical Computer.

Chapter 2: Using your Medical Computer

This chapter provides you with information on using your Medical Computer.

Appendix

This section includes notices and safety statements for your Medical Computer.

Conventions used in this manual

To highlight key information in this manual, some text are presented as follows:

WARNING! This message contains vital information regarding potential hazards, which if not avoided, could result in serious personal injury or death.

CAUTION! This message contains important information regarding potential hazards, which if not avoided, could result in minor or moderate personal injury or damage to the system or other property.

NOTE: This message contains additional information and tips that can help complete tasks.

Package contents

Your Medical Computer package contains the following items:



MDS-M700

Optional item(s)*

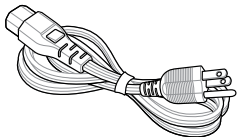

Power cord



Wi-Fi antenna

NOTE:

- *These accessories are not bundled and need to be purchased separately.
 - Some bundled accessories may vary depending on the model. For details on these accessories, refer to their respective user manuals.
 - Illustrations of the device and accessories are for reference only. Actual product specifications may vary depending on the model.
 - If the device or its components fail or malfunction during normal and proper use within the warranty period, bring the warranty card to the ASUS Service Center for replacement of the defective components.
-

1

***Getting to know your
Medical Computer***

1.1 Features

1.1.1 Front view



1

Power button

The power button allows you to turn the Medical Computer on or off. You can use the power button to put your Medical Computer to sleep mode or press it for four (4) seconds to force shutdown your Medical Computer.

1.1.2 Rear view

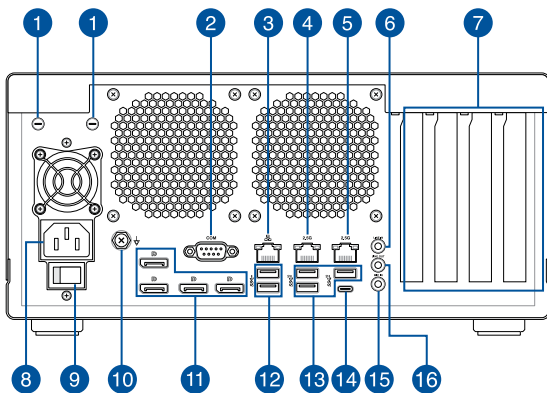

1

Wireless antenna jack

The wireless antenna jack allows you to connect a wireless antenna.

NOTE: Wireless antennas are optional and may not come bundled.

2

COM Serial (COM) connector

The 9-pin DB9 connector allows you to connect RS-232/422/485 serial (COM) devices, such as bar code scanners, modems, and printers. Please refer to the table below for the pin definitions of the different COM connectors.

NOTE: Default set to RS-232. Setting can be changed through the BIOS.

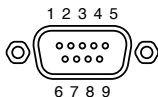

Pin	RS-232	RS-422	RS-485
1	DCD#	TX-	D-
2	RXD	TX+	D+
3	TXD	RX+	NA
4	DTR	RX-	NA
5	GND	GND	GND
6	DSR	NA	NA
7	RTS	NA	NA
8	CTS	NA	NA
9	RI	NA	NA

3



LAN port

The 8-pin RJ-45 LAN port supports 10/100/1000 Mbps connection to a Local Area Network (LAN) through the Intel® I210-AT Ethernet controller.

4

2.5G 2.5G LAN port

The 8-pin RJ-45 LAN port supports 10/100/1000/2500 Mbps connection to a Local Area Network (LAN) through the Intel® I226-V Ethernet controller..

5

2.5G 2.5G LAN port

The 8-pin RJ-45 LAN port supports Intel vPro technology and 10/100/1000/2500 Mbps connection to a Local Area Network (LAN) through the Intel® I226-LM Ethernet controller.

Intel® I210-AT LAN port LED indications

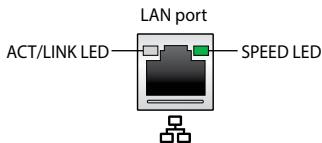

Activity Link LED	
Status	Description
Off	No link
Orange	Linked
Orange (blinking)	Data activity
Orange (blinking then steady)	Ready to wake up from S5 mode

Speed LED	
Status	Description
Off	10 Mbps connection
Orange	100 Mbps connection
Green	1 Gbps connection

Intel® I226-V/LM LAN port LED indications

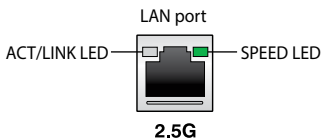

Activity Link LED	
Status	Description
Off	No link
Orange	Linked
Orange (blinking)	Data activity
Orange (blinking then steady)	Ready to wake up from S5 mode

Speed LED	
Status	Description
Off	10/100 Mbps connection
Orange	1 Gbps connection
Green	2.5 Gbps connection

6 LINE IN **Line in port (light blue)**

The line in port connects to the tape, CD, DVD player, or other audio sources.





7 **Expansion card slot**

The expansion card slot allows you to install additional hardware components, such as graphics cards or network adapters.

8 **Power input port**

The power input port allows you to connect a power cord to a power outlet.

WARNING! Use only UL-certified power cords that match the voltage of the power supply and have been approved by and comply with the safety standards of your particular country.

- 9 **Power switch**
The power switch allows you to turn on/off the power supply to your Medical Computer.
- 10  **Equipotentiality**
The equipotentiality ground brings various parts of a system to the same potential.
- 11  **Dual-mode DisplayPort**
The DisplayPort 1.4 port can support resolutions up to 3840 x 2160 @ 60 Hz on external display devices.
- 12  **USB 3.2 Gen 1 Type-A port**
The USB 3.2 Gen 1 (Universal Serial Bus) port provides a transfer rate up to 5 Gbit/s.
- 13  **USB 3.2 Gen 2 Type-A port**
The USB 3.2 Gen 2 (Universal Serial Bus) port provides a transfer rate up to 10 Gbit/s.
- 14  **USB 3.2 Gen 2 Type-C® port**
The USB 3.2 Gen 2 (Universal Serial Bus) port provides a transfer rate up to 10 Gbit/s.
- 15 MIC IN **Microphone in port (pink)**
The microphone in port is used to connect your Medical Computer to an external microphone.
- 16 LINE OUT **Line out port (lime)**
The line out port connects to a headphone or a speaker.

1.1.3 Left view

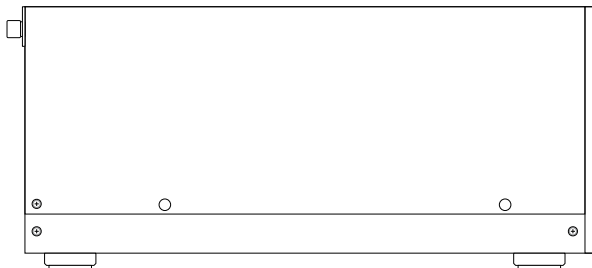

1.1.4 Right view

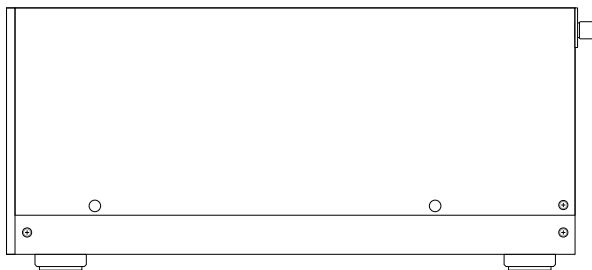

2

Using your Medical Computer

2.1 Getting started

2.1.1 Connect the power cord to your Medical Computer

To connect the power cord to your Medical Computer:



WARNING! Use only medical-grade power cords that comply with IEC/UL 60320 and equipped with the correct plug for your power source.

- Connect the female end of the power cord to your Medical Computer's power socket (refer to the **Rear view** section for the location).
- Plug the other end of the power cord to a grounded (earthed) electrical outlet.

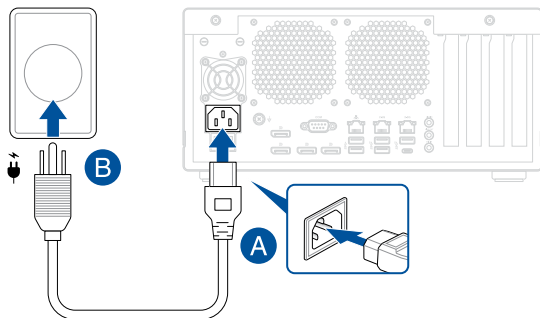

**WARNING!**

- Do not use switching power supplies or batteries from other devices to reduce the risk of injury to persons due to fire or explosion. Use only UL certified switching power supplies or batteries supplied by the manufacturer or authorized retailers.
 - Do not disable or remove the power cord grounding plug, the grounding is an important safety feature.
 - Make sure to plug the power cord into a grounded (earthed) electrical outlet that is easily accessible at all times.
-

NOTE: The power cord is purchased separately and may vary in appearance, depending on model and your region.



CAUTION!

- We strongly recommend that you use only UL-certified power cords that meet the following requirements or ones that you purchased as an option with your Medical Computer.

Power supply

Input voltage:	100-240 Vac
Input frequency:	50-60 Hz
Output power:	500 W
Output voltage/current:	+3.3 V / 20 A
	+5 V / 20 A
	+12 V1 / 16 A
	+12 V2 / 16 A
	+12 V3 / 16 A
	+5 V sb / 3 A
	-12 V / 0.5 A
	-12 V / 0.2 A

System

Rated voltage:	100-240 Vdc
Rated current:	8 A - 4 A (500 W)
Operating temperature:	0°C to 40°C

- We suggest using a power supply with 50-60 Vdc for DC-in that complies with the safety requirements of a regulated power source.
 - We strongly recommend that you use a grounded wall socket while using your Medical Computer.
 - The socket outlet must be easily accessible and near your Medical Computer.
 - To disconnect your Medical Computer from its main power supply, unplug your Medical Computer from the power socket.
-

2.1.2 Connect a display panel to your Medical Computer

You can connect a display panel or projector to your Medical Computer that has the following connector(s):

- DisplayPort

To connect a display panel to your Medical Computer:

Connect one end of a DisplayPort cable to an external display, and the other end of the cable to your Medical Computer's DisplayPort.

Connect display via DisplayPort

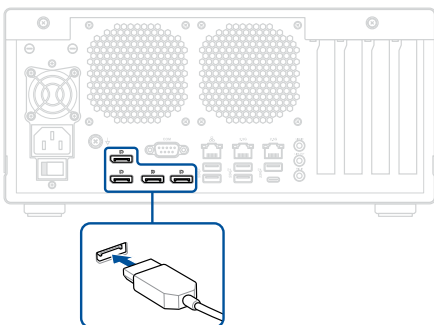

2.1.3 Connect the USB cable from keyboard or mouse

You can connect generally any USB keyboard and mouse to your Medical Computer. You can also connect a USB dongle for a wireless keyboard and mouse set.

To connect a keyboard and mouse to your Medical Computer:

Connect the USB cable from your keyboard and mouse to any of the USB ports of your Medical Computer.

NOTE:

- The keyboard varies with country and/or region.
 - The keyboard and mouse are purchased separately.
-

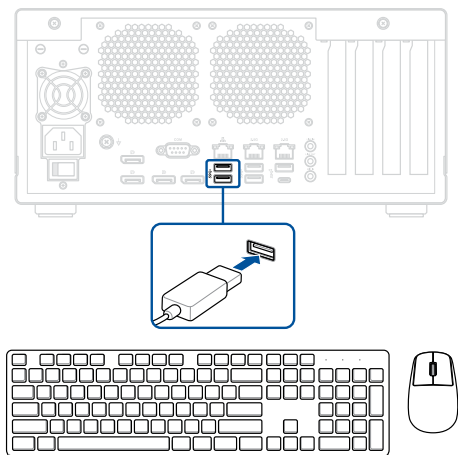

2.1.4 Turn on your Medical Computer

Press the power button to turn on your Medical Computer if it does not power on automatically when you connect it to a power source.



2.2 Turning off your Medical Computer

If your Medical Computer is unresponsive, press and hold the power button for at least five (5) seconds until your Medical Computer turns off.

Appendix







Safety instructions

Your Medical Computer is designed and tested to meet the latest standards of safety for medical equipment. However, to ensure your safety, it is important that you read the following safety instructions.

Before you start

- Read and follow carefully all instructions in this user manual to install, operate, and maintain this system. You must fully understand and adhere strictly adhere to all instructions.
- Keep this manual in a safe place for future reference.

Symbols and labels used

Symbol	Definition	Standard
	Caution, risk of electric shock	ISO 60417-6042
	Caution Consult accompanying documents	ISO 7000-0434
	Direct current	IEC 60417-5031
	Alternating current	IEC 60417-5032
	Equipotentiality	IEC 60417-5021
	Standby	IEC 60417-5009
	Follow instructions for use	IEC 60601-1, Table D.2, Symbol 10 & ISO 7101-M002

Setting up the system



Installation is only to be carried out by trained and authorized personnel

- Set up the system on a stable surface or mount it securely using an appropriate apparatus to prevent the risk of injury.
 - Do not use this system near liquids or a heated source.
 - To prevent potential damage to the system from short circuits, do not allow liquids to come into contact with this system.
 - Do not use this system in the presence of a flammable anesthetic mixture with medical air, oxygen, or nitrous oxide.
 - This system is not suitable for use with life support systems.
 - To prevent the system from overheating, do not block the air vents or place the system in direct sunlight or near heaters.
-



Do not place the system on any soft material, such as a pillow, when it is on. The material may block the airflow, causing the system to overheat.

- To ensure that all devices connected to this system are at the same potential, use the equipotential ground located in the rear (refer to the **Rear view** section for the location).
-



To avoid the risk of electric shock, this system must only be connected to a supply mains with protective earth.

- The installer is responsible for ensuring that the equipment is installed in compliance with applicable hospital, local, and national electrical codes.
 - Ensure grounding reliability by connecting this system only to receptacles marked "Hospital Only" or "Hospital Grade."
-



You must use a power cord with a three-prong grounding plug (a plug with a third grounding pin), which will only fit a grounded power outlet. If you are unable to insert the plug due to an ungrounded power outlet, contact a licensed electrician to replace it with a properly grounded one.

- Use only UL-certified switching power supplies and cords that match the voltage of the power outlet and have been approved by and comply with the safety standards of your particular country.
- If you use an extension cord, make sure that the total ampere rating of the devices plugged into the extension cord does not exceed its ampere rating.
- Peripherals with extended tolerance (such as industrial grade memory and storage) will allow this product to be used in environments with ambient temperatures between -25°C and 70°C with adequate air flow.
- This equipment should be installed and operated with a minimum distance of 20 cm between the radiator and your body.

Care during use



To reduce the risk of electric shock, never remove the cover of a device while it is in operation or connected to a power source.

- Ensure that the Signal Input/Output Part (SIP/SOP) and the patient do not come into contact at the same time.
- Do not walk on the power cord or allow anything to rest on it.
- Do not spill water or any other liquids on your system.
- When the system is turned off, a small amount of electrical current still flows. Always unplug the power cord from the power outlets before cleaning the system.
- Use this system with care when operating at full load, as the system, especially the outer casing, may reach elevated temperatures.

- If you encounter the following technical problems with the system, unplug the power cord and contact a qualified service technician or your retailer.
 - The power cord or plug is frayed or otherwise damaged.
 - Liquid has been spilled into the system.
 - The system does not function properly even if you follow the operating instructions.
 - The system was dropped or the cabinet is damaged.
 - The system performance changed.

Cleaning and disinfecting

- Before cleaning or disinfecting the surface, ensure to turn off the system and disconnect it from its power source.
- Wipe all exterior surfaces with a clean cloth dampened with an acceptable cleaning agent, and follow by thoroughly wiping the same surfaces with a clean dry cloth. Acceptable cleaning agents include the following:
 - 10% sodium hypochlorite water solution
 - Solution made of 90% water, 6% benzyl alcohol, and 3% hydrogen peroxide
 - 2.4% activated glutaraldehyde disinfectant solution



- Do not allow liquids to enter the system or its peripherals. If you accidentally spill liquid on the system, immediately disconnect it from the power source and contact your IT department.
 - Do not use autoclave, solvents, abrasive detergents, or chemical cleaning cloths.
 - Do not immerse this system or any part of it in water or any other liquids.
-

Upgrading and servicing the system

- Do not modify this system without authorization from the manufacturer.
- Repairs should only be performed by qualified service technicians or your system integrator.
- Before conducting maintenance or service, ensure to power off and disconnect from the power outlet to prevent electric shock.
- Do not replace the battery yourself. Contact a qualified service technician or your system integrator

Medical equipment compliance

- Devices, accessories, and parts connected must meet the requirements of the applicable IEC 60601 series safety standards, and the resulting system must meet the requirements set forth by the following standards:
 - EN 60601-1 (IEC 60601-1)
Medical electrical equipment Part 1: General requirements for safety
 - EN 60601-1-1 (IEC 60601-1-1)
Medical electrical equipment Part 1-1: General requirements for safety
Collateral standard: Safety requirements for Medical electrical systems
 - EN 60601-1-2 (IEC 60601-1-2)
Medical electrical equipment Part 1-2: General requirements for safety
Collateral standard: Electromagnetic compatibility; Requirements and tests
- Accessory equipment connected to analog and digital interfaces must be in compliance with the IEC 62368-1 standard for audio/video and information and communication technology equipment.

Furthermore, all configurations shall comply with the system standard IEC 60601-1-1. Anyone who connects additional equipment to the signal input part or signal output part is configuring a medical system and is therefore responsible that the system complies with the requirements of the system standard IEC 60601-1-1. The unit is for exclusive interconnection with IEC 60601-1 certified equipment in the patient environment and IEC 60XXX certified equipment outside of the patient environment. If in doubt, consult the technical services department or your local representative.

- The use of devices, accessories, and parts that do not comply with the equivalent safety requirements of this equipment may lead to a reduced level of safety of the resulting system.
- Restricted Access Area:
The equipment should only be installed in a Restricted Access Area where both these conditions apply:
 - access can only be gained by skilled persons who have been instructed about the reasons for the restrictions applied to the area and about any precautions that shall be taken; and
 - access is through the use of a TOOL or lock and key, or other means of security, and is controlled by the authority responsible for the area.
- This device shall not be connected to an Ethernet network with outside plant routing.

Lithium-Ion Battery Warning

CAUTION: Danger of explosion if battery is incorrectly replaced. Replace only with the same or equivalent type recommended by the manufacturer. Dispose of used batteries according to the manufacturer's instructions.

NO DISASSEMBLY

The warranty does not apply to the products that have been disassembled by users



DO NOT throw the Medical Computer in municipal waste. This product has been designed to enable proper reuse of parts and recycling. This symbol of the crossed out wheeled bin indicates that the product (electrical, electronic equipment, and mercury-containing button cell battery) should not be placed in municipal waste. Check local technical support services for product recycling.

Regulatory notices

FCC Compliance Information

Responsible Party: Asus Computer International

Address: 48720 Kato Rd., Fremont, CA 94538, USA

Phone / Fax No: (510)739-3777 / (510)608-4555

This device complies with Part 15 of the FCC Rules. Operation is subject to the following two conditions: (1) This device may not cause harmful interference, and (2) This device must accept any interference received including interference that may cause undesired operation.

This equipment has been tested and found to comply with the limits for a Class A digital device, pursuant to part 15 of the FCC Rules. These limits are designed to provide reasonable protection against harmful interference when the equipment is operated in a commercial environment.

This equipment generates, uses, and can radiate radio frequency energy and, if not installed and used in accordance with the instruction manual, may cause harmful interference to radio communications. Operation of this equipment in a residential area is likely to cause harmful interference in which case the user will be required to correct the interference at his own expense.

CAUTION! Outdoor operations in the 5.15~5.25 GHz band is prohibited. This device has no Ad-hoc capability for 5250~5350 and 5470~5725 MHz.

CAUTION! Any changes or modifications not expressly approved by the party responsible for compliance could void the user's authority to operate the equipment.

Compliance Statement of Innovation, Science and Economic Development Canada (ISED)

This device complies with Innovation, Science and Economic Development Canada licence exempt RSS standard(s). Operation is subject to the following two conditions: (1) this device may not cause interference, and (2) this device must accept any interference, including interference that may cause undesired operation of the device.

CAN ICES-003(A)/NMB-003(A)

Déclaration de conformité de Innovation, Sciences et Développement économique Canada (ISED)

Le présent appareil est conforme aux CNR d'Innovation, Sciences et Développement économique Canada applicables aux appareils radio exempts de licence. L'exploitation est autorisée aux deux conditions suivantes : (1) l'appareil ne doit pas produire de brouillage, et (2) l'utilisateur de l'appareil doit accepter tout brouillage radioélectrique subi, même si le brouillage est susceptible d'en compromettre le fonctionnement.

CAN ICES-003(A)/NMB-003(A)

KC: Korea Warning Statement

Class A:

사용자 안내문

이 기기는 업무용 환경에서 사용할 목적으로 적합성평가를 받은 기기로서 가정용 환경에서 사용하는 경우 전파간섭의 우려가 있습니다.

Safety Precautions

Accessories that came with this product have been designed and verified for the use in connection with this product. Never use accessories for other products to prevent the risk of electric shock or fire.

安全上のご注意

付属品は当該専用品です。他の機器には使用しないでください。機器の破損もしくは、火災や感電の原因となることがあります。

Declaration of compliance for product environmental regulation

ASUS follows the green design concept to design and manufacture our products, and makes sure that each stage of the product life cycle of ASUS product is in line with global environmental regulations. In addition, ASUS disclose the relevant information based on regulation requirements.

Please refer to <https://esg.asus.com/Compliance.htm> for information disclosure based on regulation requirements ASUS is complied with.

EU REACH and Article 33

Complying with the REACH (Registration, Evaluation, Authorization, and Restriction of Chemicals) regulatory framework, we publish the chemical substances in our products at ASUS REACH website at

<https://esg.asus.com/Compliance.htm>

EU RoHS

This product complies with the EU RoHS Directive. For more details, see

<https://esg.asus.com/Compliance.htm>

Japan JIS-C-0950 Material Declarations

Information on Japan RoHS (JIS-C-0950) chemical disclosures is available on

<https://esg.asus.com/Compliance.htm>

India RoHS

This product complies with the “India E-Waste (Management) Rules, 2016” and prohibits use of lead, mercury, hexavalent chromium, polybrominated biphenyls (PBBs) and polybrominated diphenyl ethers (PBDEs) in concentrations exceeding 0.1% by weight in homogenous materials and 0.01% by weight in homogenous materials for cadmium, except for the exemptions listed in Schedule II of the Rule.

Vietnam RoHS

ASUS products sold in Vietnam, on or after September 23, 2011, meet the requirements of the Vietnam Circular 30/2011/TT-BCT.

Các sản phẩm ASUS bán tại Việt Nam, vào ngày 23 tháng 9 năm 2011 trở về sau, đều phải đáp ứng các yêu cầu của Thông tư 30/2011/TT-BCT của Việt Nam.

Türkiye RoHS

AEEE Yönetmeliğine Uygundur

ASUS Recycling/Takeback Services

ASUS recycling and takeback programs come from our commitment to the highest standards for protecting our environment. We believe in providing solutions for you to be able to responsibly recycle our products, batteries, other components as well as the packaging materials. Please go to <https://esg.asus.com/en/Takeback.htm> for detailed recycling information in different regions.

Ecodesign Directive

The European Union announced a framework for the setting of ecodesign requirements for energy-related products (2009/125/EC). Specific implementing measures are aimed at improving environmental performance of specific products or across multiple product types. ASUS provides product information at <https://esg.asus.com/Compliance.htm>.

甲類警語

警告：為避免電磁干擾，本產品不應安裝或使用於住宅環境。

China Compulsory Certification

警告：在居住環境中，運行此設備可能會造成無線電干擾。

「產品之限用物質含有情況」之相關資訊，請參考下表：

Taiwan Declaration of Restricted Substances Marking

單元 (Unit)	限用物質及其化學符號 (Restricted substances and its chemical symbols)					
	鉛 Lead (Pb)	汞 Mercury (Hg)	鎘 Cadium (Cd)	六價鉻 Hexavalent chromium (Cr ⁶⁺)	多溴聯苯 Polybrominated biphenyls (PBB)	多溴二苯醚 Polybrominated diphenyls ethers (PBDE)
印刷電路板 及電子組件 PCB	—	○	○	○	○	○
外殼 Chassis	—	○	○	○	○	○
硬碟 Disk drive	—	○	○	○	○	○
散熱設備 Thermal solutions	—	○	○	○	○	○
其他及其 配件 (線材等) Accessories (e.g., cables)	—	○	○	○	○	○

備考 1. “○” 係指該項限用物質之百分比含量未超出百分比含量基準值。

備考 2. “—” 係指該項限用物質為排除項目。

Note 1 “○” indicates that the percentage content of the restricted substance does not exceed the percentage of reference value of presence.

Note 2 The “—” indicates that the restricted substance corresponds to the exemption.

UK: The Radio Equipment Regulations 2017 (S.I. 2017/1206)

Simplified UKCA Declaration of Conformity

ASUSTek Computer Inc. hereby declares that this device is in compliance with the essential requirements and other relevant provisions of The Radio Equipment Regulations 2017 (S.I. 2017/1206). Full text of UKCA declaration of conformity is available at <https://www.asus.com/support/>.

The WiFi operating in the band 5150-5350MHz shall be restricted to indoor use for country listed below:

UK

EU: Radio Equipment Directive (Directive 2014/53/EU)

Simplified EU Declaration of Conformity

ASUSTek Computer Inc. hereby declares that this device is in compliance with the essential requirements and other relevant provisions of Directive 2014/53/EU. Full text of EU declaration of conformity is available at <https://www.asus.com/support/>.

The WiFi operating in the band 5150-5350MHz shall be restricted to indoor use for countries listed in the table below:

Déclaration simplifiée de conformité de l'UE

ASUSTek Computer Inc. déclare par la présente que cet appareil est conforme aux critères essentiels et autres clauses pertinentes de la directive 2014/53/EU. La déclaration de conformité de l'UE peut être téléchargée à partir du site internet suivant :

<https://www.asus.com/support/>

Dans la plage de fréquence 5150-5350 MHz, le Wi-Fi est restreint à une utilisation en intérieur dans les pays listés dans le tableau ci-dessous:

Vereinfachte EU-Konformitätserklärung

ASUSTek COMPUTER INC erklärt hiermit, dass dieses Gerät mit den grundlegenden Anforderungen und anderen relevanten Bestimmungen der Richtlinie 2014/53/EU übereinstimmt. Der gesamte Text der EU-Konformitätserklärung ist verfügbar unter:

<https://www.asus.com/support/>

Der WLAN-Betrieb im Band von 5150-5350 MHz ist für die in der unteren Tabelle aufgeführten Länder auf den Innenbereich beschränkt:

Dichiarazione di conformità UE semplificata

ASUSTek Computer Inc. con la presente dichiara che questo dispositivo è conforme ai requisiti essenziali e alle altre disposizioni pertinenti con la direttiva 2014/53/EU. Il testo completo della dichiarazione di conformità UE è disponibile all'indirizzo:

<https://www.asus.com/support/>

L'utilizzo della rete Wi-Fi con frequenza compresa nell'intervallo 5150-5350MHz deve essere limitato all'interno degli edifici per i paesi presenti nella seguente tabella:

Упрощенное заявление о соответствии европейской директиве

ASUSTek Computer Inc. заявляет, что устройство соответствует основным требованиям и другим соответствующим условиям директивы 2014/53/EU. Полный текст декларации соответствия ЕС доступен на <https://www.asus.com/support/>

Работа WiFi в диапазоне частот 5150-5350 должна быть ограничена использованием в помещениях для стран, перечисленных в таблице ниже:

إعلان التوافق المبسط الصادر عن الاتحاد الأوروبي

تقر شركة ASUSTek Computer أن هذا الجهاز يتوافق مع المتطلبات الأساسية والأحكام الأخرى ذات الصلة الخاصة بتوجيه 2014/53. يتوفر النص الكامل لإعلان التوافق الصادر عن الاتحاد الأوروبي على:

<https://www.asus.com/support/>

يجب حصر استخدام WiFi العاملة بـ 5150-5350 ميجا هرتز على الاستخدام المنزلي للبلدان المدرجة بالجدول.

Опростена декларация за съответствие на ЕС

С настоящото ASUSTek Computer Inc. декларира, че това устройство е в съответствие със съществените изисквания и другите приложими постановления на свързаната Директива 2014/53/ЕС. Пълният текст на ЕС декларация за съвместимост е достъпен на адрес <https://www.asus.com/support/>

WiFi, работеща в диапазон 5150-5350MHz, трябва да се ограничи до употреба на закрито за страните, посочени в таблицата по-долу:

Declaração de Conformidade UE Simplificada

ASUSTek Computer Inc. declara que este dispositivo está em conformidade com os requisitos essenciais e outras disposições relevantes relacionadas às diretivas 2014/53/UE. O texto completo da declaração de conformidade CE está disponível em <https://www.asus.com/support/>

O WiFi operando na banda 5150-5350MHz deve ser restrito para uso interno para os países listados na tabela abaixo:

Pojednostavljena EU Izjava o sukladnosti

ASUSTek Computer Inc. ovim izjavljuje da je ovaj uređaj sukladan s bitnim zahtjevima i ostalim odgovarajućim odredbama direktive 2014/53/EU. Cijeli tekst EU izjave o sukladnosti dostupan je na <https://www.asus.com/support/>

WiFi koji radi na opsegu frekvencija 5150-5350 MHz bit će ograničen na upotrebu u zatvorenom prostoru u zemljama na donjem popisu:

Zjednodušené prohlášení o shodě EU

Společnost ASUSTek Computer Inc. tímto prohlašuje, že toto zařízení splňuje základní požadavky a další příslušná ustanovení směrnice 2014/53/EU. Plné znění prohlášení o shodě EU je k dispozici na adrese <https://www.asus.com/support/>

V zemích uvedených v tabulce je provoz sítě Wi-Fi ve frekvenčním rozsahu 5 150 - 5 350 MHz povolen pouze ve vnitřních prostorech:

Forenklet EU-overensstemmelseerklæring

ASUSTEK Computer Inc. erklærer hermed at denne enhed er i overensstemmelse med hovedkravene og øvrige relevante bestemmelser i direktivet 2014/53/EU. Hele EU-overensstemmelseerklæringen kan findes på <https://www.asus.com/support/>

Wi-Fi, der bruger 5150-5350 MHz skal begrænses til indendørs brug i lande, der er anført i tabellen:

Vereenvoudigd EU-conformiteitsverklaring

ASUSTEK Computer Inc. verklaart hierbij dat dit apparaat voldoet aan de essentiële vereisten en andere relevante bepalingen van Richtlijn 2014/53/EU. De volledige tekst van de EU-conformiteitsverklaring is beschikbaar op <https://www.asus.com/support/>

De WiFi op 5150-5350MHz zal beperkt zijn tot binnengebruik voor in de tabel vermelde landen:

Lihtsustatud EÜ vastavusdeklaratsioon

Käesolevaga kinnitab ASUSTEK Computer Inc, et seade vastab direktiivi 2014/53/EÜ olulistele nõuetele ja teistele asjakohastele sätetele. EÜ vastavusdeklaratsiooni täistekst on saadaval veebisaidil <https://www.asus.com/support/>

Sagedusvahemikus 5150-5350 MHz töötava WiFi kasutamine on järgmistes riikides lubatud ainult siseruumides:

Eurooppa - EY:n vaatimustenmukaisuusvakuutus

ASUSTek Computer Inc. ilmoittaa täten, että tämä laite on direktiivin 2014/53/EU olennaisista vaatimusten ja muiden asiaankuuluvien lisäysten mukainen. Koko EY:n vaatimustenmukaisuusvakuutuksen teksti on luettavissa osoitteessa <https://www.asus.com/support/>

5 150 - 5 350 MHz:in taajuudella toimiva WiFi on rajoitettu sisäkäyttöön taulukossa luetelluissa maissa:

تبعیت از نسخه ساده شده بیانیه اتحادیه اروپا

ASUSTek Computer Inc در اینجا اعلام می کند که این دستگاه با نیازهای اساسی و سایر مقررات مربوط به بیانیه 2014/53/EU مطابقت دارد. متن کامل پیروی از این بیانیه اتحادیه اروپا در این آدرس موجود است: <https://www.asus.com/support/>

عملکرد 5150-5350 مگاهرتز برای WiFi باید برای استفاده در فضای داخل ساختمان برای کشورهای فهرست شده در جدول، محدود شود.

Απλοποιημένη Δήλωση Συμμόρφωσης ΕΕ

Διά του παρόντος η ASUSTek Computer Inc. δηλώνει ότι αυτή η συσκευή είναι σύμμορφη με τις βασικές προϋποθέσεις και άλλες σχετικές διατάξεις της Οδηγίας 2014/53/ΕΕ. Το πλήρες κείμενο της δήλωσης συμμόρφωσης της ΕΕ είναι διαθέσιμο στη διεύθυνση <https://www.asus.com/support/>

To WiFi που λειτουργεί στη ζώνη 5150-5350MHz περιορίζεται για χρήση σε εσωτερικούς χώρους για τις χώρες που αναφέρονται στον παρακάτω πίνακα:

הצהרת תאימות רגולטורית מקוצרת עבור האיחוד אירופי

ASUSTek Computer Inc. מצהירה בזאת כי מכשיר זה תואם לדרישות החיוביות ולשאר הסעיפים הרלוונטיים של תקנה 2014/53/EU. ניתן לקרוא את הנוסח המלא של הצהרת התאימות הרגולטורית עבור האיחוד האירופי בכתובת: <https://www.asus.com/support/>

יש להגביל רשתות Wi-Fi הפועלות ברצועת התדרים 5150-5350MHz לשימוש בתוך מבנים סגורים בארצות המפורסות ברשימה הבאה:

Egyszerűsített EU megfelelési nyilatkozat

Az ASUSTek Computer Inc. ezennel kijelenti, hogy ez az eszköz megfelel az 2014/53/EU sz. irányelv alapvető követelményeinek és egyéb vonatkozó rendelkezéseinek. Az EU megfelelési nyilatkozat teljes szövegét a következő weboldalon tekintheti meg: <https://www.asus.com/support/>

Az 5150-5350 MHz-es sávban működő Wi-Fi-t beltéri használatra kell korlátozni az alábbi táblázatban felsorolt országokban:

Pernyataan Kesesuaian UE yang Disederhanakan

ASUSTek Computer Inc. dengan ini menyatakan bahwa perangkat ini memenuhi persyaratan utama dan ketentuan relevan lainnya yang terdapat pada Petunjuk 2014/53/EU. Teks lengkap pernyataan kesesuaian EU tersedia di: <https://www.asus.com/support/>

WiFi yang Beroperasi pada 5150-5350 MHz akan terbatas untuk penggunaan dalam ruangan di negara yang tercantum dalam tabel

Vienkāršota ES atbilstības paziņojums

ASUSTek Computer Inc. ar šo paziņo, ka šī ierīce atbilst Direktīvas 2014/53/ES būtiskajām prasībām un citiem citiem saistošajiem nosacījumiem. Pilns ES atbilstības paziņojuma teksts pieejams šeit: <https://www.asus.com/support/>

Wi-Fi darbība 5150–5350 MHz ir jāierobežo lietošanai telpās valstīs, kuras norādītas tālāk.

Supraprastinta EU atitikties deklaracija

Šiame dokumente bendrovė „ASUSTek Computer Inc.“ pareiškia, kad šis prietaisas atitinka pagrindinius reikalavimus ir kitas susijusias Direktyvos 2014/53/ES nuostatas. Visas EU atitikties deklaracijos tekastas pateikiamas čia: <https://www.asus.com/support/>

Toliau nurodytose šalyse „WiFi“ ryšiu, veikiančiu 5 150–5 350 MHz dažnio juostoje, galima naudotis tik patalpose:

Forenklet EU-samsvarserklæring

ASUSTek Computer Inc. erklærer herved at denne enheten er i samsvar med hovedsaklige krav og andre relevante forskrifter i direktivet 2014/53/EU. Fullstendig tekst for EU-samsvarserklæringen finnes på: <https://www.asus.com/support/>

Wi-Fi-området 5150–5350 MHz skal begrenses til innendørs bruk for landene som er oppført i tabellen:

Uproszczona deklaracja zgodności UE

Firma ASUSTek Computer Inc. niniejszym oświadczam, że urządzenie to jest zgodne z zasadniczymi wymogami i innymi właściwymi postanowieniami dyrektywy 2014/53/EU. Pełny tekst deklaracji zgodności UE jest dostępny pod adresem <https://www.asus.com/support/>

W krajach wymienionych w tabeli działanie sieci Wi-Fi w paśmie 5150–5350 MHz powinno być ograniczone wyłącznie do pomieszczeń:

Declaração de Conformidade Simplificada da UE

A ASUSTek Computer Inc. declara que este dispositivo está em conformidade com os requisitos essenciais e outras disposições relevantes da Diretiva 2014/53/UE. O texto integral da declaração de conformidade da UE está disponível em <https://www.asus.com/support/>

A utilização das frequências WiFi de 5150 a 5350MHz está restrita a ambientes interiores nos países apresentados na tabela:

Declarație de conformitate UE, versiune simplificată

Prin prezenta, ASUSTek Computer Inc. declară că acest dispozitiv este în conformitate cu reglementările esențiale și cu celelalte prevederi relevante ale Directivei 2014/53/UE. Textul complet al declarației de conformitate UE este disponibil la adresa <https://www.asus.com/support/>

Pentru țările listate în tabelul de mai jos, rețelele WiFi care funcționează în banda de frecvență de 5.150-5.350 MHz trebuie utilizate doar în interior:

Pojednostavljena Deklaracija o usaglašenosti EU

ASUSTek Computer Inc. ovim izjavljuje da je ovaj uređaj usaglašen sa osnovnim zahtevima i drugim relevantnim odredbama Direktive 2014/53/EU. Ceo tekst Deklaracije o usaglašenosti EU dostupan je na lokaciji <https://www.asus.com/support/>

WiFi koji radi u frekventnom opsegu od 5150 MHz do 5350 MHz ograničen je isključivo na upotrebu u zatvorenom prostoru za zemlje navedene u tabeli ispod:

Zjednodušené vyhlášení o zhode platné pre EÚ

Spoločnosť ASUSTek Computer Inc. týmto vyhlasuje, že toto zariadenie je v súlade so základnými požiadavkami a ďalšími príslušnými ustanoveniami smernice č. 2014/53/EÚ. Plné znenie vyhlásenia o zhode pre EÚ je k dispozícii na lokalite <https://www.asus.com/support/>

Činnosť WiFi v pásme 5150 - 5350 MHz bude obmedzená na použitie vo vnútornom prostredí pre krajiny uvedené v tabuľke nižšie:

nostavljena izjava EU o skladnosti

ASUSTek Computer Inc. tukaj izjavlja, da je ta naprava skladna s temeljnimi zahtevami in drugimi relevantnimi določili Direktive 2014/53/EU. Polno besedilo izjave EU o skladnosti je na voljo na <https://www.asus.com/support/>

WiFi, ki deluje v pasovnem območju 5150–5350 MHz, mora biti v državah, navedenih v spodnjem seznamu, omejen na notranjo uporabo:

Declaración de conformidad simplificada para la UE

Por la presente, ASUSTek Computer Inc. declara que este dispositivo cumple los requisitos básicos y otras disposiciones pertinentes de la directiva 2014/53/EU. En <https://www.asus.com/support/> está disponible el texto completo de la declaración de conformidad para la UE.

La conexión WiFi con una frecuencia de funcionamiento de 5150-5350 MHz se restringirá al uso en interiores para los países enumerados en la tabla:

Förenklad EU-försäkran om överensstämmelse

ASUSTek Computer Inc. deklarerar härmed att denna enhet överensstämmer med de grundläggande kraven och andra relevanta bestämmelser i direktiv 2014/53/EU. Fullständig text av EU-försäkran om överensstämmelse finns på <https://www.asus.com/support/>

WiFi som använder 5150-5350 MHz kommer att begränsas för användning inomhus i de länder som anges i tabellen:

ประกาศเกี่ยวกับความสอดคล้องของสหภาพยุโรปแบบย่อ

ASUSTek Computer Inc. ขอประกาศในที่นี้ว่าอุปกรณ์นี้มีความสอดคล้องกับความต้องการที่จำเป็นและเงื่อนไขที่เกี่ยวข้องอื่น ๆ ของบทบัญญัติข้อกำหนด 2014/53/EU เนื้อหาที่สมบูรณ์ของประกาศความสอดคล้องกับ EU มีอยู่ที่ <https://www.asus.com/support/>

การทำงานของ WiFi ที่ 5150-5350MHz ถูกจำกัดให้ใช้ในอาคารสำหรับประเทศที่แสดงในตาราง

Basitleştirilmiş AB Uyumluluk Bildirimi

ASUSTek Computer Inc., bu aygıtın 2014/53/EU Yönergesinin temel gereksinimlerine ve diğer ilgili hükümlerine uygun olduğunu bildirir. AB uyumluluk bildiriminin tam metni şu adreste bulunabilir: <https://www.asus.com/support/>

5150-5350 MHz arasındaki WiFi çalışması, tabloda listelenen ülkeler için iç mekân kullanımıyla kısıtlanacaktır.

Спрощена декларація про відповідність нормам ЄС

ASUSTek Computer Inc. заявляє, що цей пристрій відповідає основним вимогам та іншим відповідним вимогам Директиви 2014 / 53 / EU. Повний текст декларації відповідності нормам ЄС доступний на <https://www.asus.com/support/>

Робота Wi-Fi на частоті 5150-5350 МГц обмежується використанням у приміщенні для країн, поданих у таблиці нижче:

AT	BE	BG	CZ	DK	EE	FR
DE	IS	IE	IT	EL	ES	CY
LV	LI	LT	LU	HU	MT	NL
NO	PL	PT	RO	SI	SK	TR
FI	SE	CH	HR	UK (NI)		

RF Module Warning Statement

RF modules are intended for OEM or host integrators only. For availability of system level RF certification, check with your OEM integrator.

Service and Support

Visit our multi-language website at <https://www.asus.com/support/>.



