

Zenfone[™] 6

User Manual

ASUS[®]

E8829

First Edition

February 2014

Model: ASUS_T00G

Copyright © 2014 ASUSTeK COMPUTER INC.

All Rights Reserved.

No part of this manual, including the products and software described in it, may be reproduced, transmitted, transcribed, stored in a retrieval system, or translated into any language in any form or by any means, except documentation kept by the purchaser for backup purposes, without the express written permission of ASUSTeK COMPUTER INC. ("ASUS").

Product warranty or service will not be extended if: (1) the product is repaired, modified or altered, unless such repair, modification or alteration is authorized in writing by ASUS; or (2) the serial number of the product is defaced or missing.

ASUS PROVIDES THIS MANUAL "AS IS" WITHOUT WARRANTY OF ANY KIND, EITHER EXPRESS OR IMPLIED, INCLUDING BUT NOT LIMITED TO THE IMPLIED WARRANTIES OR CONDITIONS OF MERCHANTABILITY OR FITNESS FOR A PARTICULAR PURPOSE. IN NO EVENT SHALL ASUS, ITS DIRECTORS, OFFICERS, EMPLOYEES OR AGENTS BE LIABLE FOR ANY INDIRECT, SPECIAL, INCIDENTAL, OR CONSEQUENTIAL DAMAGES (INCLUDING DAMAGES FOR LOSS OF PROFITS, LOSS OF BUSINESS, LOSS OF USE OR DATA, INTERRUPTION OF BUSINESS AND THE LIKE), EVEN IF ASUS HAS BEEN ADVISED OF THE POSSIBILITY OF SUCH DAMAGES ARISING FROM ANY DEFECT OR ERROR IN THIS MANUAL OR PRODUCT.

SPECIFICATIONS AND INFORMATION CONTAINED IN THIS MANUAL ARE FURNISHED FOR INFORMATIONAL USE ONLY, AND ARE SUBJECT TO CHANGE AT ANY TIME WITHOUT NOTICE, AND SHOULD NOT BE CONSTRUED AS A COMMITMENT BY ASUS. ASUS ASSUMES NO RESPONSIBILITY OR LIABILITY FOR ANY ERRORS OR INACCURACIES THAT MAY APPEAR IN THIS MANUAL, INCLUDING THE PRODUCTS AND SOFTWARE DESCRIBED IN IT.

Products and corporate names appearing in this manual may or may not be registered trademarks or copyrights of their respective companies, and are used only for identification or explanation and to the owners' benefit, without intent to infringe.

Thank you for purchasing this ASUS product!
Before you start, ensure that you have read all the safety information and operating instructions in this **User Manual** to prevent injury or damage to your device.

NOTE: For the latest updates and more detailed information, please visit www.asus.com.

Getting started with your ZenFone 6

Front features



Side features

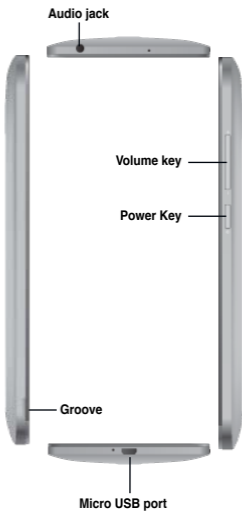

NOTE: Pry open the rear cover from the groove.

Rear features



NOTES:

- Remove the rear cover to display the dual micro SIM and microSD card slots.
 - The micro SIM card slots support WCDMA, DC-HSPA, and GSM/EDGE network bands.
 - The microSD card slot supports microSD and microSDHC card formats.
-

Charging your ZenFone 6

After installing your micro SIM card, we strongly recommend that you charge your device fully before powering it ON.

To charge your ZenFone 6:

1. Connect the USB connector into the power adapter's USB port.
2. Connect the other end of the micro USB cable to your ZenFone 6.
3. Plug the power adapter into a wall socket.

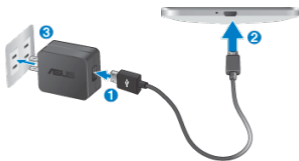

IMPORTANT!

- When using your ZenFone 6 while it is plugged to a power outlet, the grounded power outlet must be near to the unit and easily accessible.
 - When charging your ZenFone 6 through your computer, ensure that you plug the micro USB cable to your computer's USB 2.0 / USB 3.0 port.
 - Avoid charging your ZenFone 6 in an environment with ambient temperature of above 35°C (95°F).
-

NOTES:

- Use only the power adapter that came with your device. Using a different power adapter may damage your device.
 - Using the bundled power adapter and ZenFone 6 signal cable to connect your ZenFone 6 to a power outlet is the best way to charge your ZenFone 6.
 - The input voltage range between the wall outlet and this adapter is AC 100V - 240V. The output voltage of the micro USB cable is DC 5.2V, 1.35A.
-

Turning your ZenFone 6 on or off

Press the power key at the side of your ZenFone 6 to power the device on or to power it off.



IMPORTANT: The first time you power on your ZenFone 6, you will see the Welcome screen. Touch the menu to select your preferred language then touch **Next Step**. Follow the onscreen instructions to set up your ZenFone 6.

Installing a micro SIM card

To install a micro SIM card:

1. Locate the groove on the bottom-left corner of your ZenFone 6.

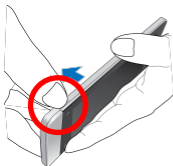

2. Pry the cover loose and then pull the rear cover off.

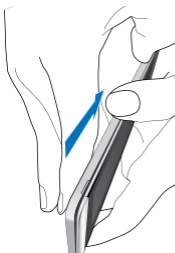

3. Insert the micro SIM card into one of the slots.



4. Replace the rear cover.

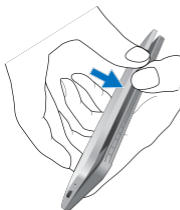

5. Press down the rear cover on all sides to secure it in place.



IMPORTANT:

- Both micro SIM card slots support 3G WCDMA network band. But only one micro SIM card can connect to 3G WCDMA service at a time.
- Use only a micro SIM card on your ZenFone 6. A trimmed SIM card may not properly fit into and may not be detected by your ZenFone 6.

NOTE: All specifications are subject to change without notice and may vary by country and region.

Installing a microSD card

To install a microSD card:

1. Locate the groove on the bottom-left corner of your ZenFone 6.

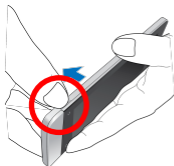

2. Pry the cover loose and then pull the rear cover off.

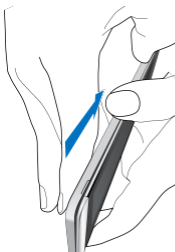

2. Insert the microSD card into the microSD card slot.



4. Replace the rear cover.

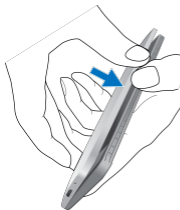

5. Press down the rear cover on all sides to secure it in place.



CE RF Exposure Compliance

This device meets the EU requirements (1999/519/EC) on the limitation of exposure of the general public to electromagnetic fields by way of health protection.

For body-worn operation, this device has been tested and meets the ICNIRP guidelines and the European Standard EN 62209-2, for use with dedicated accessories. SAR is measured with this device at a separation of 1.5 cm to the body, while transmitting at the highest certified output power level in all frequency bands of this device. Use of other accessories which contain metals may not ensure compliance with ICNIRP exposure guidelines.

CE Mark Warning



CE marking for devices with wireless LAN/ Bluetooth

This equipment complies with the requirements of Directive 1999/5/EC of the European Parliament and Commission from 9 March, 1999 governing Radio and Telecommunications Equipment and mutual recognition of conformity.

The highest CE SAR values for the device are as follows:

- 0.397 W/Kg (Body/GSM 900)
- 0.367 W/Kg (Head/GSM 900)

Specific Absorption Rate (SAR)

Band	Position	SAR- 10g (W/kg)
GSM900	Head	0.367
	Body (1.5cm Gap)	0.397
GSM1800	Head	0.306
	Body (1.5cm Gap)	0.325
WCDMA I	Head	0.187
	Body (1.5cm Gap)	0.248
WCDMA VIII	Head	0.190
	Body (1.5cm Gap)	0.211
2.4G WLAN	Head	0.303
	Body (1.5cm Gap)	0.061
MAX SAR	Head	0.367
	Body (1.5cm Gap)	0.397

Prevention of Hearing Loss

To prevent possible hearing damage, do not listen at high volume levels for long periods.



À pleine puissance, l'écoute prolongée du baladeur peut endommager l'oreille de l'utilisateur.

For France, headphones/earphones for this device are compliant with the sound pressure level requirement laid down in the applicable EN 50332-1:2000 and/or EN50332-2:2003 standard required by French Article L.5232-1.

Safety information

ZenFone 6 care

- Do not leave your ZenFone 6 exposed to strong sunlight or excessive heat for a prolonged period. This may damage it.
- Do not handle your ZenFone 6 device with wet hands or expose it to moisture or liquids of any kind. Continuous changes from a cold to a warm environment may lead to condensation inside your ZenFone 6, resulting in corrosion and possible damage.
- When traveling, avoid packing the device inside a suitcase. Cramping the device into a suitcase may crack the LCD display. Remember to switch off your wireless connection during air travel.
- Use your ZenFone 6 in an environment with ambient temperatures between -10 °C (14 °F) and 35 °C (95 °F).

IMPORTANT! To provide electrical insulation and maintain electrical safety, a coating is applied to insulate the ASUS ZenFone 6 body except on the sides where the I/O ports are located.

The battery

Your ZenFone 6 is equipped with a high performance non-detachable Li-Ion battery. Observe the maintenance guidelines for a longer battery life.

- Do not remove the non-detachable Li-ion battery as this will void the warranty.
- Avoid charging in extremely high or low temperature. The battery performs optimally in an ambient temperature of +5 °C to +35 °C.
- Do not remove and replace the battery with a non-approved battery.
- Do not remove and soak the battery in water or any other liquid.
- Never try to open the battery as it contains substances that might be harmful if swallowed or allowed to come into contact with unprotected skin.
- Do not remove and short-circuit the battery, as it may overheat and cause a fire. Keep it away from jewelry or metal objects.
- Do not remove and dispose of the battery in fire. It could explode and release harmful substances into the environment.
- Do not remove and dispose of the battery with your regular household waste. Take it to a hazardous material collection point.
- Do not touch the battery terminals.

NOTES:

- Risk of explosion if battery is replaced by an incorrect type.
 - Dispose of used battery according to the instructions.
-

- Ensure to fully charge the battery before using your ZenFone 6 for extended periods. Remember that the power adapter charges the battery as long as it is plugged into a power source. Be aware that it takes much longer to charge the battery when your ZenFone 6 is in use.

IMPORTANT! Do not leave your ZenFone 6 connected to the power source once it is fully charged. Your ZenFone 6 is not designed to be connected to the power source for extended periods of time.

The charger

- Use only the charger supplied with your ZenFone 6.
- Never pull the charger cord to disconnect it from the power socket. Pull the charger itself.

Cleaning and storing

- Your ZenFone 6 should always be handled with care and protected from dirt, dust and dampness. To avoid scratches, never place your ZenFone 6 face down.

- If cleaning is necessary, turn your ZenFone 6 off and wipe carefully with a soft, slightly damp (not wet) cloth. Use a cotton swab to clean the camera lens. Allow your ZenFone 6 to dry completely before switching it on. Never use solvents for cleaning.
- If you are not going to use your ZenFone 6 for some time, fully charge the battery and store your ZenFone 6 in a dry place away from direct sunlight. Your ZenFone 6 should be switched off during storage. Recharge every 6 to 12 months.
- Never expose your ZenFone 6 to heat or strong sunlight.
- Never expose your ZenFone 6 to moisture or liquids of any kind.
- Do not place stickers that may block the keypad or affect other components such as the microphone, earpiece or camera lens.

WARNING! Failure to follow these instructions may lead to serious personal injury and possible property damage.

Driving safely

Never use handheld phones while driving. It is an offence, that while driving, to hold a phone or cradle it in your neck at any point, during the setup, making or taking of a phone call, text message or any other data related mobile communication. Use of fully installed car kits are still permitted, as are the use of alternate handsfree accessories.

In the interest of safety, we would recommend the use of a cradle while using any form of handsfree accessory.

While driving, we recommend that you use voicemail wherever possible, and that you listen to your messages when you are not in the car. If you must make a handsfree call when driving, keep it brief.

Do not place objects, including both installed or portable wireless equipment, in the area over the airbag or in the airbag deployment area. An airbag inflates with great force. If the airbag inflates, serious injury could result.

Electronic devices

Most modern electronic equipment is shielded from RF energy.

However, certain electronic equipment may not be shielded against the RF signals from your device.

Pacemakers

The Health Industry Manufacturers' Association recommends that a minimum separation of six (6") inches be maintained between a phone and a pacemaker to avoid potential interference with the pacemaker. These recommendations are consistent with the independent research by and recommendations of Wireless Technology Research.

If you have a pacemaker:

- Always keep your ZenFone 6 more than six inches (15cm) from your pacemaker when turned on.
- Do not carry your ZenFone 6 in your breast pocket.

- Use the ear opposite the pacemaker to minimize the potential for interference.
- If you have any reason to suspect that interference is taking place, switch off your ZenFone 6 immediately.

Hearing aids

Some digital phones may interfere with some hearing aids. In the event of such interference, call ASUS Customer Service to discuss alternatives.

Other medical devices

If you use any other personal medical device, consult the manufacturer of your device to determine if it is adequately shielded from external RF energy. Your physician may be able to assist you in obtaining this information.

Turn your ZenFone 6 off in healthcare facilities when any regulations posted in these areas instruct you to do so.

Hospitals or healthcare facilities may be using equipment that could be sensitive to external RF energy.

Vehicles

RF signals may affect improperly installed or inadequately shielded electronic systems in motor vehicles. Check with the manufacturer or its representative regarding your vehicle. You should also consult the manufacturer of any equipment added to your vehicle.

Posted facilities

Turn your ZenFone 6 off where posted notices so require.

Magnetic media

Magnetic fields generated by mobile devices may damage data on magnetic storage media, such as credit cards, computer discs or tapes. Do not place your ZenFone 6 next to such media.

You should never expose your ZenFone 6 to strong magnetic fields as this may cause temporary malfunction.

Other Safety Guidelines

Aircraft

Regulations prohibit using your mobile device while onboard an aircraft. Switch off your ZenFone 6 before boarding an aircraft or turn off the wireless connection.

Blasting areas

To avoid interfering with blasting operations, turn your ZenFone 6 off when in a 'blasting area' or in areas posted: "Turn off two-way radio." Obey all signs and instructions.

Potentially explosive environments

Turn your ZenFone 6 off when in any area with a potentially explosive environment and obey all signs and instructions.

Sparks in such areas could cause an explosion or fire resulting in bodily injury or even death.

Areas with a potentially explosive environment are often, but not always, clearly marked. They include fuelling areas such as gas stations, below decks on boats, fuel or chemical transfer or storage facilities, vehicles using liquified petroleum gas (such as propane or butane), areas where the air contains chemicals or articles, such as grain, dust, or metal powders, and any other area where you would normally be advised to turn off your vehicle's engine.

Choking

Keep your ZenFone 6 away from children as the SIM card and other small parts present a choking hazard.

Caution

Your ZenFone 6 is a high quality piece of equipment. Before operating, read all instructions and cautionary markings on the (1) AC Adapter.

- Do not use the ZenFone 6 in an extreme environment where high temperature or high humidity exists. The ZenFone 6 performs optimally in an ambient temperature between -10 °C (14 °F) and 35 °C (95 °F).
- Do not abuse the ZenFone 6. Avoid striking, shaking, or subjecting the device to impact. When not using the unit, place the device in a safe place to avoid damage to the product.
- Do not expose the ZenFone 6 to rain or moisture.
- Do not use unauthorized accessories.

- Do not disassemble the ZenFone 6 or its accessories. If service or repair is required, return the unit to an authorized service center. If the unit is disassembled, a risk of electric shock or fire may result.
- Do not short-circuit the battery terminals with metal items.

Operator access with a tool

If a TOOL is necessary to gain access to an OPERATOR ACCESS AREA, either all other compartments within that area containing a hazard shall be inaccessible to the OPERATOR by the use of the same TOOL, or such compartments shall be marked to discourage OPERATOR access.

ASUS

**Address: 15 Li-Te Road, Peitou, Taipei,
Taiwan**

Tel: 886228943447

Fax: 886228907698

Declaration

We declare that the IMEI codes for this product, **ASUS ZenFone 6**, are unique to each unit and only assigned to this model. The IMEI of each unit is factory set and cannot be altered by the user and that it complies with the relevant IMEI integrity related requirements expressed in the GSM standards.

Should you have any questions or comments regarding this matter, please contact us.

Sincerely yours,

ASUSTeK COMPUTER INC.

Tel: 886228943447

Fax: 886228907698

Support:

<http://vip.asus.com/eservice/techserv.aspx>

EC Declaration of Conformity



We, the undersigned,

Manufacturer:	ASUSTEK COMPUTER INC.
Address, City:	4F, No. 150, Li-Tseng Rd., Peitong, Taipei 112, TAIWAN
Country:	TAIWAN
Authorized representative in Europe:	ASUS COMPUTER GmbH
Address, City:	HARKORT STR. 21-23, 40880 RATINGSON
Country:	GERMANY

declare the following apparatus:

Product name :	ASUS ZenFone 6
Model name :	ASUS_T00G

conform with the essential requirements of the following directives:

<input checked="" type="checkbox"/> 2014/53/EC-EMC Directive	<input checked="" type="checkbox"/> EN 55022:2010-AC:2011 Class B <input checked="" type="checkbox"/> EN 61000-3-2:2006-A2:2009 <input checked="" type="checkbox"/> EN 55013:2001-A1:2003-A2:2006	<input checked="" type="checkbox"/> EN 55024:2010 <input checked="" type="checkbox"/> EN 61000-3-2:2006 <input checked="" type="checkbox"/> EN 55025:2007-A1:2011
---	---	---

<input checked="" type="checkbox"/> 2006/95/EC-LVD Directive	<input checked="" type="checkbox"/> EN 300 320 V1.8.1(2009-01) <input checked="" type="checkbox"/> EN 300 440-1 V1.8.1(2010-08) <input checked="" type="checkbox"/> EN 300 440-2 V1.4.1(2010-08) <input checked="" type="checkbox"/> EN 301 911 V9.2.3(2003-03) <input checked="" type="checkbox"/> EN 301 888-1 V8.2.1(2011-06) <input checked="" type="checkbox"/> EN 301 888-2 V8.4.1(2011-07) <input checked="" type="checkbox"/> EN 301 880 V1.8.1(2011-11) <input checked="" type="checkbox"/> EN 302 544-2 V1.1.1(2009-07) <input checked="" type="checkbox"/> EN 302 623 V1.1.1(2009-07) <input checked="" type="checkbox"/> EN 50365:2007-A1:2012 <input checked="" type="checkbox"/> EN 62476:2010 <input checked="" type="checkbox"/> EN 62209-1:2006 <input checked="" type="checkbox"/> EN 62209-2:2010 <input checked="" type="checkbox"/> EN 62365:2002	<input checked="" type="checkbox"/> EN 301 489-1 V1.8.2(2011-09) <input checked="" type="checkbox"/> EN 301 489-2 V1.8.1(2010-08) <input checked="" type="checkbox"/> EN 301 489-4 V1.4.1(2009-05) <input checked="" type="checkbox"/> EN 301 489-7 V1.3.1(2009-11) <input checked="" type="checkbox"/> EN 301 489-9 V1.4.1(2007-11) <input checked="" type="checkbox"/> EN 301 489-17 V2.2.1(2010-09) <input checked="" type="checkbox"/> EN 301 489-20 V1.5.1(2010-08) <input checked="" type="checkbox"/> EN 302 326-2 V1.2.2(2007-06) <input checked="" type="checkbox"/> EN 302 326-3 V1.3.1(2007-06) <input checked="" type="checkbox"/> EN 301 281-2 V1.4.1(2009-11) <input checked="" type="checkbox"/> EN 302 281-1 V1.1.1(2009-07) <input checked="" type="checkbox"/> EN 302 281-2 V1.1.1(2009-07) <input checked="" type="checkbox"/> EN 62311:2008 <input checked="" type="checkbox"/> EN 50366:2012
---	---	--

<input checked="" type="checkbox"/> 2006/95/EC-LVD Directive	<input checked="" type="checkbox"/> EN 60950-1:2006/A1:2009-A1:2010-A12:2011 <input checked="" type="checkbox"/> EN 60330-1:2005	<input type="checkbox"/> EN 60950:2002 / A12:2011
---	---	---

<input type="checkbox"/> 1989/125/EC-EP Directive	<input type="checkbox"/> Regulation (EC) No. 1275/2008 <input type="checkbox"/> Regulation (EC) No. 642/2009	<input checked="" type="checkbox"/> Regulation (EC) No. 278/2009 <input checked="" type="checkbox"/> Regulation (EC) No. 817/2013
--	---	--

2011/65/EU-ROHS Directive Ver. 130816

CE marking

CE 0700 (EC conformity marking)

Position : **CEO**
Name : **Jerry Shen**

Signature : _____

Declaration Date: 07/02/2014
Year to begin affixing CE marking: 2014

EC Declaração de Conformidade



Nós, os abaixo assinados,

Fabricante:	ASUSTEK COMPUTER INC.
Morada, Cidade:	4F, No. 150, Li-Tseng Rd., Peitong, Taipei 112, TAIWAN
País:	TAIWAN
Representante autorizado na Europa:	ASUS COMPUTER GmbH
Morada, Cidade:	HARKORT STR. 21-23, 40880 RATINGSON
País:	GERMANY

declaramos que o seguinte produto:

Nome do Produto :	ASUS ZenFone 6
Modelo :	ASUS_T00G

se encontra em conformidade com as exigências essenciais das seguintes diretivas:

<input checked="" type="checkbox"/> 2004/108/EC-EMC Directive	<input checked="" type="checkbox"/> EN 55022:2010-AC:2011 Class B <input checked="" type="checkbox"/> EN 61000-3-2:2006-A2:2009 <input checked="" type="checkbox"/> EN 55013:2001-A1:2003-A2:2006	<input checked="" type="checkbox"/> EN 55024:2010 <input checked="" type="checkbox"/> EN 61000-3-2:2006 <input checked="" type="checkbox"/> EN 55025:2007-A1:2011
--	---	---

<input checked="" type="checkbox"/> 2006/95/EC-LVD Directive	<input checked="" type="checkbox"/> EN 300 320 V1.8.1(2009-01) <input checked="" type="checkbox"/> EN 300 440-1 V1.8.1(2010-08) <input checked="" type="checkbox"/> EN 300 440-2 V1.4.1(2010-08) <input checked="" type="checkbox"/> EN 301 911 V9.2.3(2003-03) <input checked="" type="checkbox"/> EN 301 888-1 V8.2.1(2011-06) <input checked="" type="checkbox"/> EN 301 888-2 V8.4.1(2011-07) <input checked="" type="checkbox"/> EN 301 880 V1.8.1(2011-11) <input checked="" type="checkbox"/> EN 302 544-2 V1.1.1(2009-07) <input checked="" type="checkbox"/> EN 302 623 V1.1.1(2009-07) <input checked="" type="checkbox"/> EN 50365:2007-A1:2012 <input checked="" type="checkbox"/> EN 62476:2010 <input checked="" type="checkbox"/> EN 62209-1:2006 <input checked="" type="checkbox"/> EN 62209-2:2010 <input checked="" type="checkbox"/> EN 62365:2002	<input checked="" type="checkbox"/> EN 301 489-1 V1.8.2(2011-09) <input checked="" type="checkbox"/> EN 301 489-2 V1.8.1(2010-08) <input checked="" type="checkbox"/> EN 301 489-4 V1.4.1(2009-05) <input checked="" type="checkbox"/> EN 301 489-7 V1.3.1(2009-11) <input checked="" type="checkbox"/> EN 301 489-9 V1.4.1(2007-11) <input checked="" type="checkbox"/> EN 301 489-17 V2.2.1(2010-09) <input checked="" type="checkbox"/> EN 301 489-20 V1.5.1(2010-08) <input checked="" type="checkbox"/> EN 302 326-2 V1.2.2(2007-06) <input checked="" type="checkbox"/> EN 302 326-3 V1.3.1(2007-06) <input checked="" type="checkbox"/> EN 301 281-2 V1.4.1(2009-11) <input checked="" type="checkbox"/> EN 302 281-1 V1.1.1(2009-07) <input checked="" type="checkbox"/> EN 302 281-2 V1.1.1(2009-07) <input checked="" type="checkbox"/> EN 62311:2008 <input checked="" type="checkbox"/> EN 50366:2012
---	---	--

<input checked="" type="checkbox"/> 2006/95/EC-LVD Directive	<input checked="" type="checkbox"/> EN 60950-1:2006/A1:2009-A1:2010-A12:2011 <input checked="" type="checkbox"/> EN 60330-1:2005	<input type="checkbox"/> EN 60950:2002 / A12:2011
---	---	---

<input type="checkbox"/> 1989/125/EC-EP Directive	<input type="checkbox"/> Regulation (EC) No. 1275/2008 <input type="checkbox"/> Regulation (EC) No. 642/2009	<input checked="" type="checkbox"/> Regulation (EC) No. 278/2009 <input checked="" type="checkbox"/> Regulation (EC) No. 817/2013
--	---	--

2011/65/EU-ROHS Directive Ver. 130816

Marca de CE

CE 0700 (Marca de Conformidade EC)

Posição : **CEO**
Nome : **Jerry Shen**

Assinatura : _____

Data de declaração: 07/02/2014
Ano para começar a aposição da marca CE: 2014

CE Declaratie de Conformitate



Noi, subsemnatii,

Producător:	ASUSTEK COMPUTER INC.
Adresa, Grup:	Strada PIETROU Nr 195, L-TE 40q 4, TAIPEI 112, TAIWAN
Țară:	Taiwan
Reprezentant autorizat în Europa:	ASUS COMPUTER GmbH
Adresa, Grup:	Strada HARKORT Nr 21-23, RATINGSB 40380
Țară:	Germania

declaram că următorul aparat:

Nume produs:	ASUS ZenFone 6
Nume model:	ASUS_T00G

este conform cu cerințele esențiale ale următoarelor directive:

<input checked="" type="checkbox"/> Directiva 2004/108/EC-EMC	<input checked="" type="checkbox"/> EN 55022:2010+AC:2011	<input checked="" type="checkbox"/> EN 55024:2010
	<input checked="" type="checkbox"/> EN 61000-3-2:2006+AC:2009	<input checked="" type="checkbox"/> EN 61000-3-3:2008
	<input checked="" type="checkbox"/> EN 55013:2007+AT:2003+AC:2008	<input checked="" type="checkbox"/> EN 55020:2007+A1:2011

<input checked="" type="checkbox"/> Directiva 1999/5/EC-RATE	<input checked="" type="checkbox"/> EN 300 328 V1.8.1 (2010-10)	<input checked="" type="checkbox"/> EN 301 888-1 V1.8.2 (2011-08)
	<input checked="" type="checkbox"/> EN 300 440-1 V1.8.1 (2010-08)	<input checked="" type="checkbox"/> EN 301 888-2 V1.8.1 (2013-08)
	<input checked="" type="checkbox"/> EN 300 440-2 V1.4.1 (2010-08)	<input checked="" type="checkbox"/> EN 301 888-4 V1.4.1 (2009-05)
	<input checked="" type="checkbox"/> EN 301 811 V9.2 (2003-03)	<input checked="" type="checkbox"/> EN 301 888-7 V1.3.1 (2009-11)
	<input checked="" type="checkbox"/> EN 301 908-1 V8.2.1 (2011-05)	<input checked="" type="checkbox"/> EN 301 888-9 V1.4.1 (2007-11)
	<input checked="" type="checkbox"/> EN 301 908-2 V5.4.1 (2011-07)	<input checked="" type="checkbox"/> EN 301 888-17 V2.2.1 (2012-08)
	<input checked="" type="checkbox"/> EN 301 892 V1.8.1 (2011-11)	<input checked="" type="checkbox"/> EN 301 888-24 V1.8.1 (2010-09)
	<input checked="" type="checkbox"/> EN 302 564-2 V1.1.1 (2009-01)	<input checked="" type="checkbox"/> EN 302 328-2 V1.3.2 (2007-08)
	<input checked="" type="checkbox"/> EN 302 623 V1.1.1 (2009-01)	<input checked="" type="checkbox"/> EN 302 328-3 V1.3.1 (2007-08)
	<input checked="" type="checkbox"/> EN 60360:2001(A1):2012	<input checked="" type="checkbox"/> EN 301 357-2 V1.4.1 (2008-11)
	<input checked="" type="checkbox"/> EN 62479:2010	<input checked="" type="checkbox"/> EN 302 291-1 V1.1.1 (2009-07)
	<input checked="" type="checkbox"/> EN 62329-1:2008	<input checked="" type="checkbox"/> EN 302 291-2 V1.1.1 (2009-07)
	<input checked="" type="checkbox"/> EN 62329-2:2012	<input checked="" type="checkbox"/> EN 62211:2008
	<input checked="" type="checkbox"/> EN 60385:2002	<input checked="" type="checkbox"/> EN 50568:2012

<input checked="" type="checkbox"/> Directiva 2006/95/EC-LVD	<input checked="" type="checkbox"/> EN 60950-1:2006/A1:2009+A1:2010+A12:2011	<input checked="" type="checkbox"/> EN 60950-2:2002 / A12:2011
	<input checked="" type="checkbox"/> EN 60332-1:2000	

<input checked="" type="checkbox"/> Directiva 2006/125/EC-ErP	<input checked="" type="checkbox"/> Regulation (EC) No. 1275/2008	<input checked="" type="checkbox"/> Regulation (EC) No. 276/2009
<input type="checkbox"/> Regulation (EC) No. 1275/2008	<input type="checkbox"/> Regulation (EC) No. 642/2009	<input type="checkbox"/> Regulation (EC) No. 617/2013

<input checked="" type="checkbox"/> Directiva 2011/65/EU-RoHS	Ver. 130816
---	-------------

Insemnul CE

CE0700

(Insemnul de conformitate CE)

Pozitia: CEO

Nume: Jerry Shen

Data declarației: 07/02/2014

Anul aplicării insemnului CE: 2014

Semnătura: _____

EC Uygunluk Beyanı



Biz, bu imza altındaki

Ünvan:	ASUSTEK COMPUTER INC.
Adres, Grup:	4F, No. 195, L-TE Rd., PIETROU TAIPEI 112, TAIWAN
Ünvan:	TAYVAN
Avrupa'daki temsil:	ASUS COMPUTER GmbH
Adres, Grup:	HARKORT STR. 21-23, 40380 RATINGSB
Ünvan:	ALMANYA

Aşağıdaki ürünün

Ürün adı:	ASUS ZenFone 6
Model adı:	ASUS_T00G

Aşağıdaki direktiflerin gereksinimlerine uyduğunu deklare ederiz:

<input checked="" type="checkbox"/> 2004/108/EC-EMC Direktif	<input checked="" type="checkbox"/> EN 55022:2010+AC:2011 Class B	<input checked="" type="checkbox"/> EN 55024:2010
	<input checked="" type="checkbox"/> EN 61000-3-2:2006+AC:2009	<input checked="" type="checkbox"/> EN 61000-3-3:2008
	<input checked="" type="checkbox"/> EN 55013:2007+AT:2003+AC:2008	<input checked="" type="checkbox"/> EN 55020:2007+A1:2011

<input checked="" type="checkbox"/> 1999/5/EC-RATE Direktif	<input checked="" type="checkbox"/> EN 300 328 V1.8.1 (2010-10)	<input checked="" type="checkbox"/> EN 301 888-1 V1.8.2 (2011-08)
	<input checked="" type="checkbox"/> EN 300 440-1 V1.8.1 (2010-08)	<input checked="" type="checkbox"/> EN 301 888-2 V1.8.1 (2013-08)
	<input checked="" type="checkbox"/> EN 300 440-2 V1.4.1 (2010-08)	<input checked="" type="checkbox"/> EN 301 888-4 V1.4.1 (2009-05)
	<input checked="" type="checkbox"/> EN 301 811 V9.2 (2003-03)	<input checked="" type="checkbox"/> EN 301 888-7 V1.3.1 (2009-11)
	<input checked="" type="checkbox"/> EN 301 908-1 V8.2.1 (2011-05)	<input checked="" type="checkbox"/> EN 301 888-9 V1.4.1 (2007-11)
	<input checked="" type="checkbox"/> EN 301 908-2 V5.4.1 (2011-07)	<input checked="" type="checkbox"/> EN 301 888-17 V2.2.1 (2012-08)
	<input checked="" type="checkbox"/> EN 301 892 V1.8.1 (2011-11)	<input checked="" type="checkbox"/> EN 301 888-24 V1.8.1 (2010-09)
	<input checked="" type="checkbox"/> EN 302 564-2 V1.1.1 (2009-01)	<input checked="" type="checkbox"/> EN 302 328-2 V1.3.2 (2007-08)
	<input checked="" type="checkbox"/> EN 302 623 V1.1.1 (2009-01)	<input checked="" type="checkbox"/> EN 302 328-3 V1.3.1 (2007-08)
	<input checked="" type="checkbox"/> EN 60360:2001(A1):2012	<input checked="" type="checkbox"/> EN 301 357-2 V1.4.1 (2008-11)
	<input checked="" type="checkbox"/> EN 62479:2010	<input checked="" type="checkbox"/> EN 302 291-1 V1.1.1 (2009-07)
	<input checked="" type="checkbox"/> EN 62329-1:2008	<input checked="" type="checkbox"/> EN 302 291-2 V1.1.1 (2009-07)
	<input checked="" type="checkbox"/> EN 62329-2:2012	<input checked="" type="checkbox"/> EN 62211:2008
	<input checked="" type="checkbox"/> EN 60385:2002	<input checked="" type="checkbox"/> EN 50568:2012

<input checked="" type="checkbox"/> 2006/95/EC-LVD Direktif	<input checked="" type="checkbox"/> EN 60950-1:2006/A1:2009+A1:2010+A12:2011	<input checked="" type="checkbox"/> EN 60950-2:2002 / A12:2011
	<input checked="" type="checkbox"/> EN 60332-1:2000	

<input checked="" type="checkbox"/> 2006/125/EC-ErP Direktif	<input checked="" type="checkbox"/> Regulation (EC) No. 1275/2008	<input checked="" type="checkbox"/> Regulation (EC) No. 276/2009
<input type="checkbox"/> Regulation (EC) No. 1275/2008	<input type="checkbox"/> Regulation (EC) No. 642/2009	<input type="checkbox"/> Regulation (EC) No. 617/2013

<input checked="" type="checkbox"/> 2011/65/EU-RoHS Direktif	Ver. 130816
--	-------------

CE (İşareti)

CE0700

(EC uygunluk işareti)

Pozisyon : CEO

İsim : Jerry Shen

Deklarasyon Tarihi: 07/02/2014

CE İşaretinin Eklendiği Yıl: 2014

İmza : _____

