

Congratulations and thank you for buying ASUS X99-DELUXE III!

This guide displays PCI Express 3.0 Operating Mode, Recommended Memory Configurations, M.2 Bracket Installation, and other essential installation tips to make your installation process faster and more convenient!

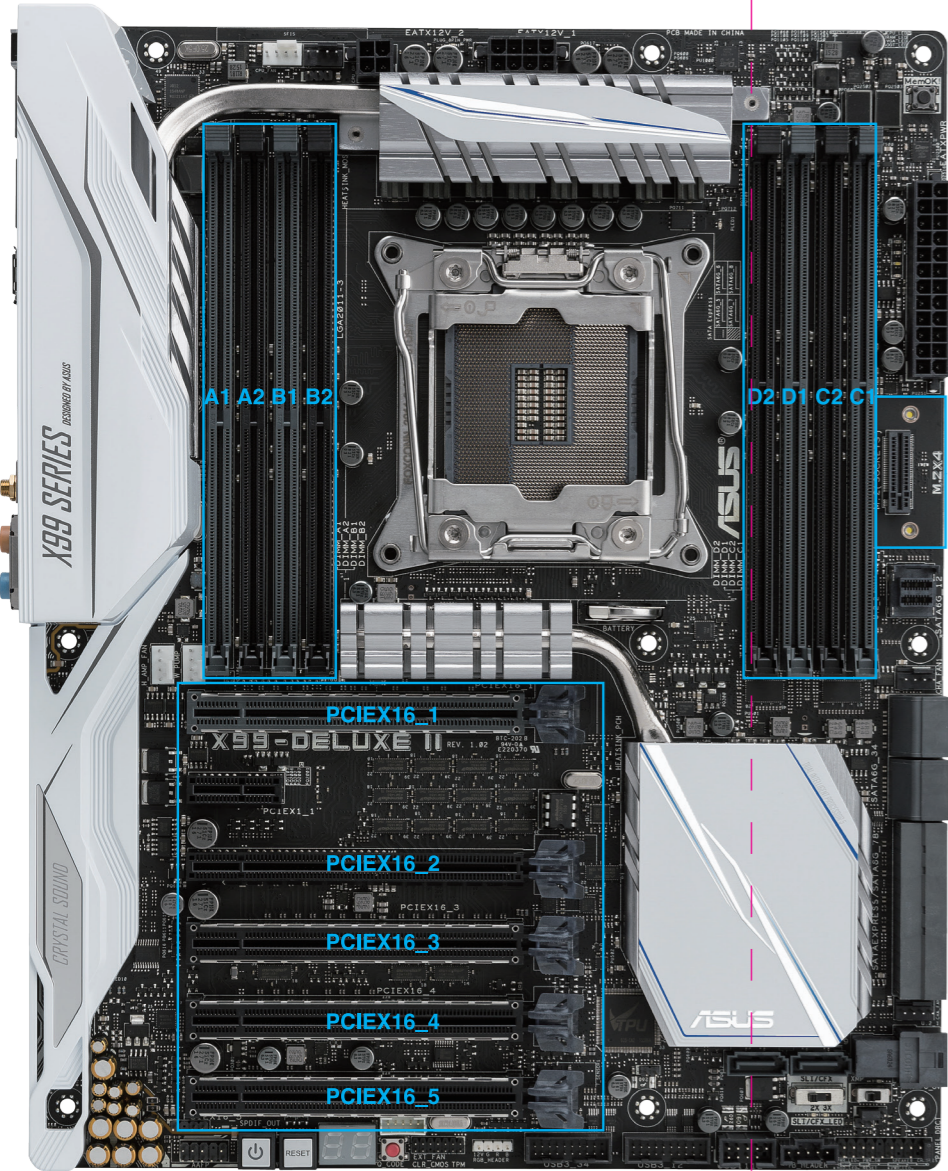

M.2 Bracket Installation Guide

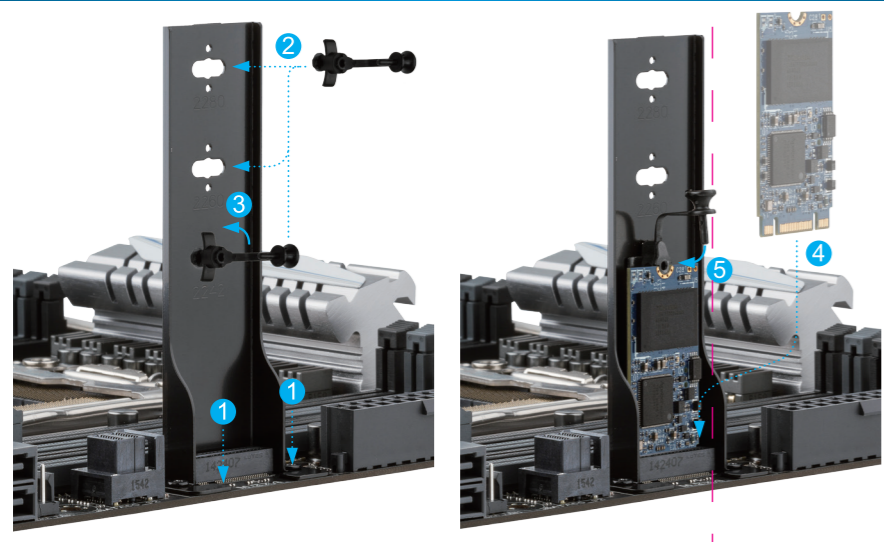

Enable SLI/CFX Switch

This switch allows you to determine the slots for 2-WAY or 3-WAY graphics card installation. When enabled, the LEDs near the slots light up, indicating the specific slots to install the graphics cards.

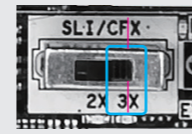

3 Way

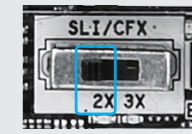

2 Way

CPU 40 lane

(1) X16/X16/X4 mode (Default, CFX only)
M.2 & U.2_2: Disabled
U.2_1: Enabled

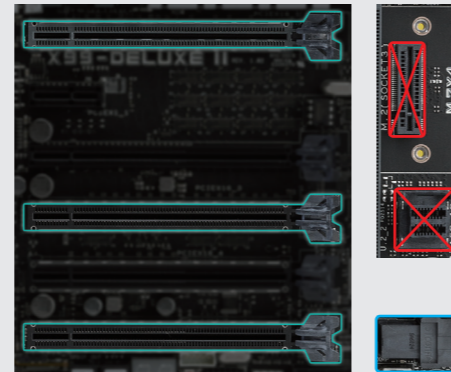

(2) X16/X16/X8
M.2 & U.2_2: Disabled
U.2_1: Disabled

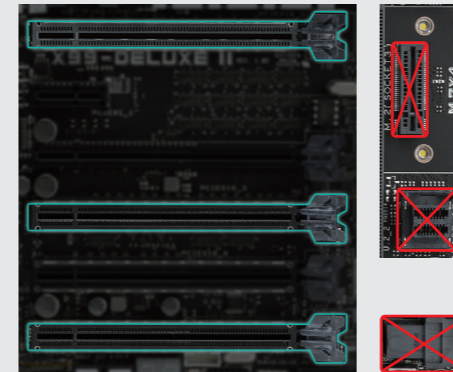

CPU 40 lane

(1) X16/X16 (Default)
M.2 & U.2_2: Disabled
U.2_1: Enabled

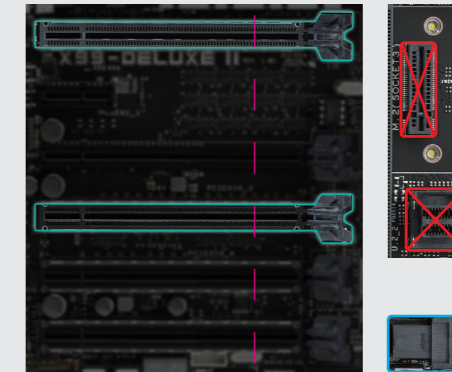

(2) X16/X8
M.2 & U.2_2: Enabled
U.2_1: Enabled

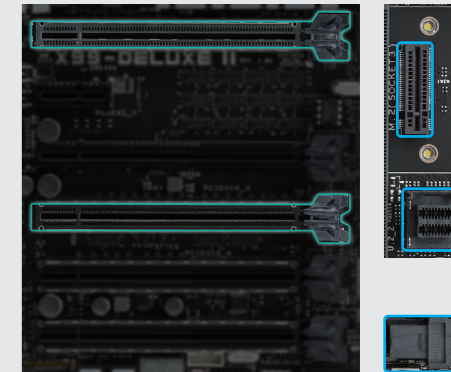

(3) X16/X8/X8 mode
M.2 & U.2_2: Enabled
U.2_1: Disabled

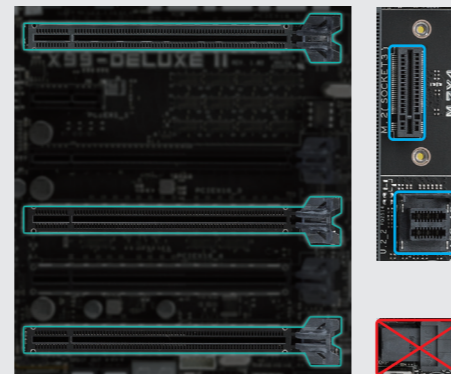

(4) X16/X8/X4 mode (CFX only)
M.2 & U.2_2: Enabled
U.2_1: Enabled

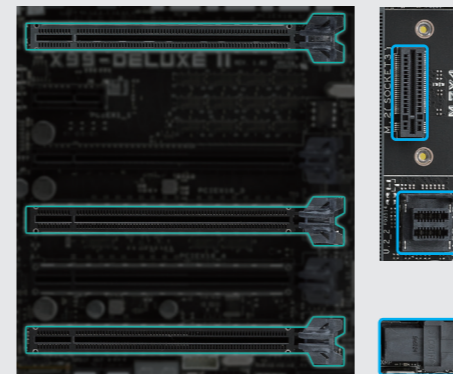

CPU 28 lane

(1) X16/X8 (Default)
M.2 & U.2_2: Disabled
U.2_1: Enabled

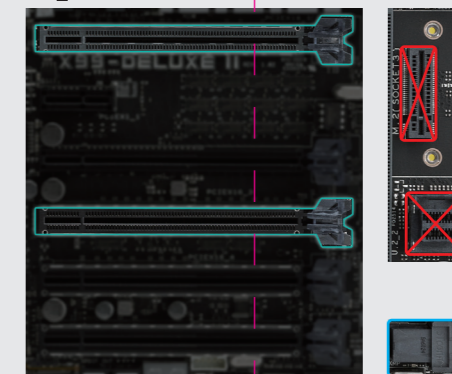

(2) X16/X4 (CFX only)
M.2 only: Enabled
U.2_1: Enabled

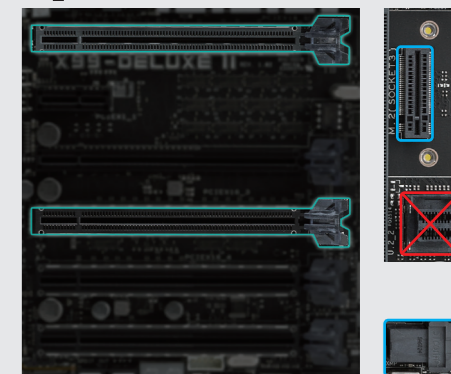

*Enabling U.2_2 will disable PCIEX16_3 slot

CPU 28 lane

(1) X8/X8/X8 (Default)
M.2 & U.2_2: Disabled
U.2_1: Enabled

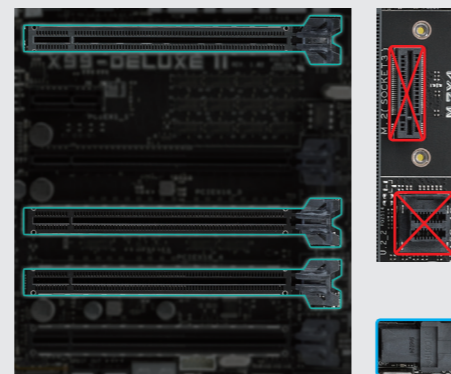

(2) X8/X4/X8 (CFX only)
M.2 only: Enabled
U.2_1: Enabled

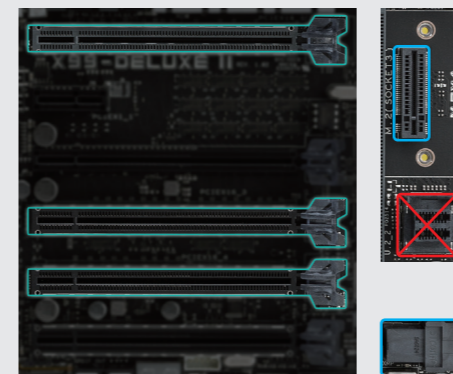

*Enabling U.2_2 will disable PCIEX16_3 slot

(3) X8/X8
M.2 & U.2_2: Enabled
U.2_1: Enabled

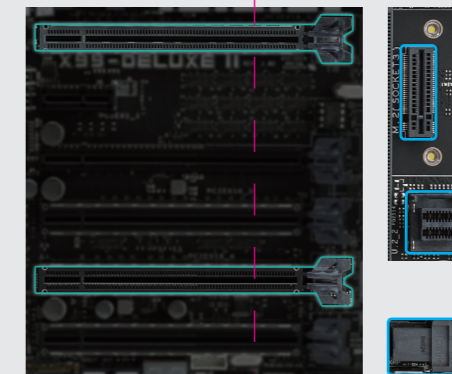

Power Connectors Installation Guide

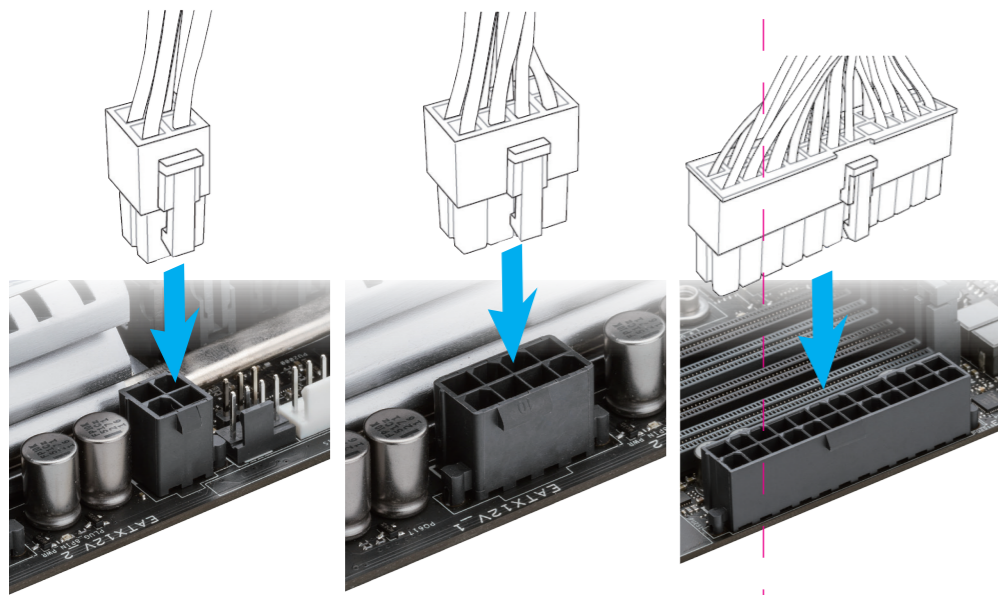

*Make sure to connect BOTH the 4-pin AND 8-pin EATX 12V power plug from your power supply to the onboard EATX 12V connectors,

Recommended Memory Configurations

For 1 module inserted

Slot: D1
Color: dark gray



For 2 modules inserted

Slots: D1 and B1
Color: dark gray



For 4 modules inserted

Slots: A1, B1, C1, D1
Color: dark gray



For 6 modules inserted

Slots: A1, B1, C1, D1, B2, D2
Color: dark gray(A1, B1, C1, D1) & black(B2, D2)

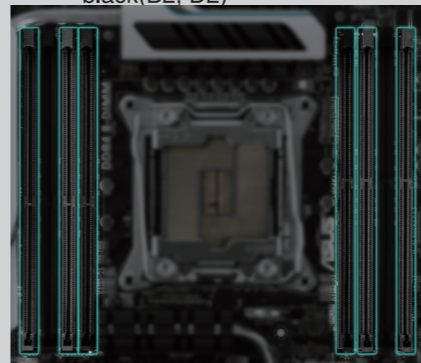

VGA Holder Installation Guide

*ASUS VGA Holder is a part of the ASUS EZ DIY KIT and sold separately.

ASUS VGA Holder provides support for heavy graphics card(s) to prevent slot damage and motherboard bending. It features smooth finish, retractable design, and multiple height adjustments for easy installation.

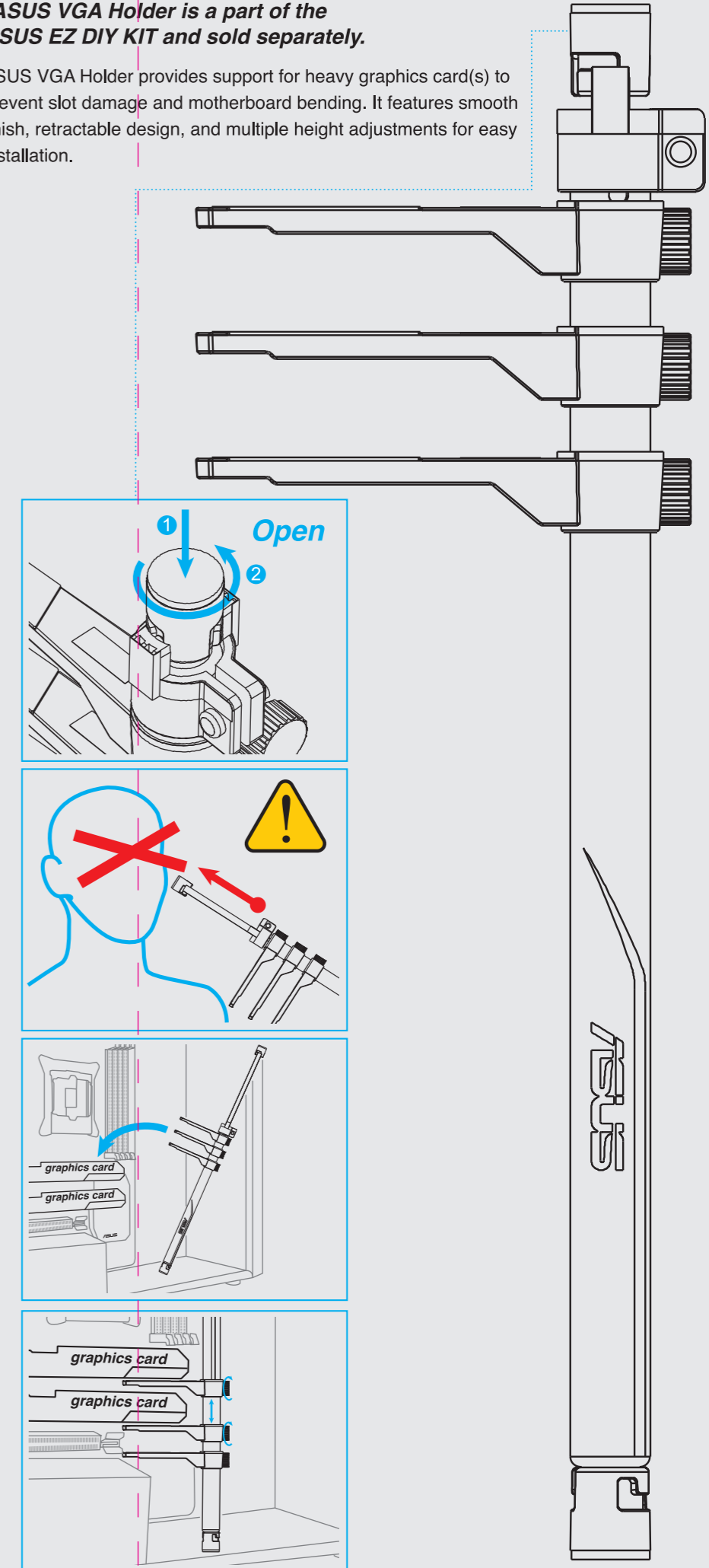

Water Cooler Installation Guide

When using a water cooling device, connect the device's fan connector(s) to the motherboard's CPU_FAN/CPU_OPT connectors, and the water pump connector to the onboard W_PUMP connector.

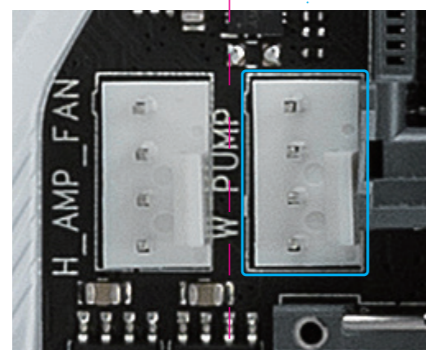
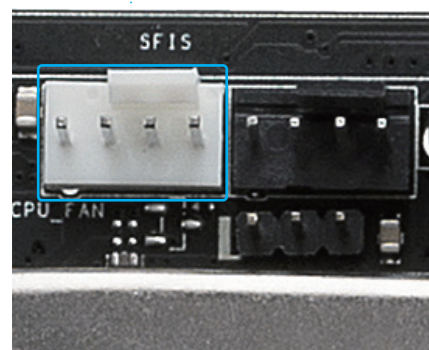
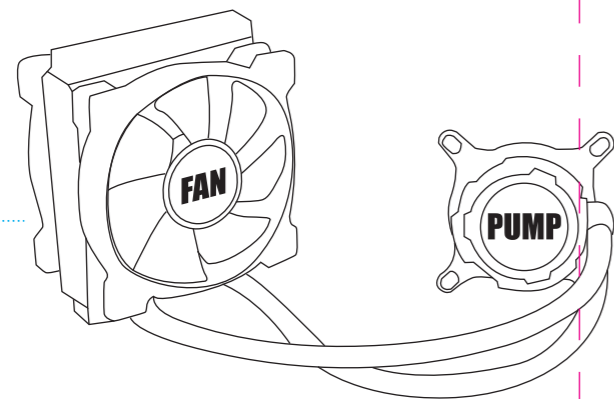

CPU Installation Guide

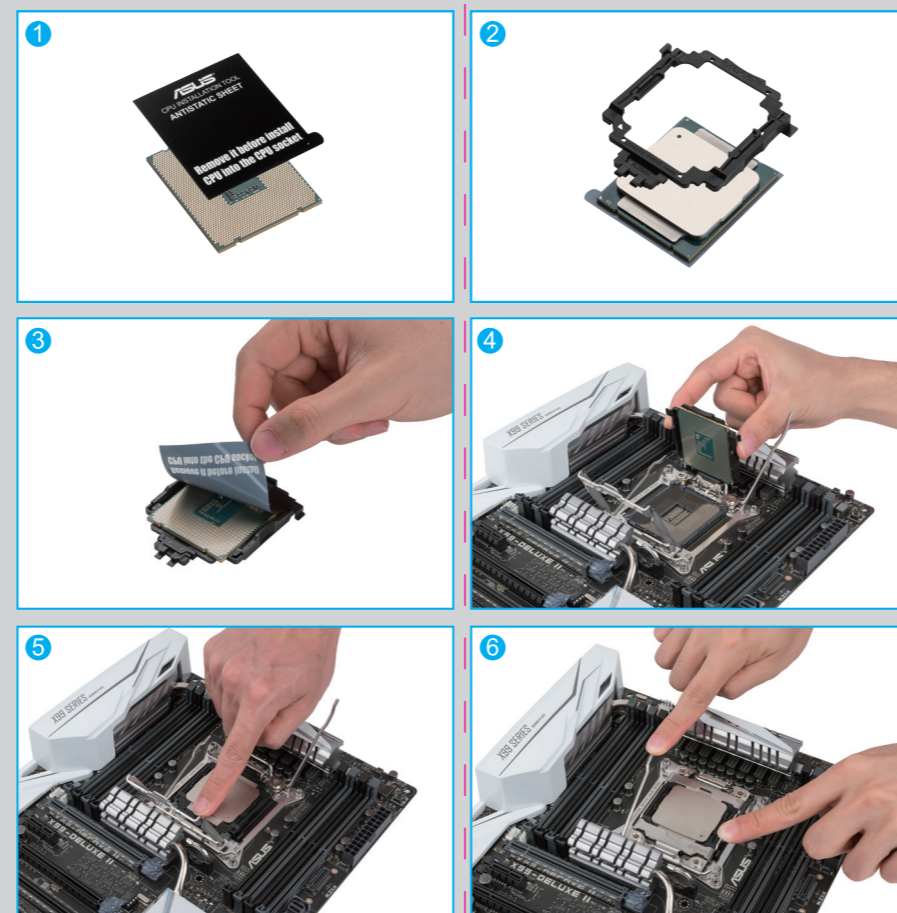

* The illustrations are for reference only.

* The CPU Installation Tool is only compatible on ASUS motherboards with an Intel® LGA2011-V3 socket.