



# **Rail Kit Installation Manual**

**TS Series**

# 1. Rail kit installation

## 1.1 Preparing the system for rack mounting



- The items required for the optional configurations described in this manual are not included in the standard barebone system package. These items are purchased separately.
- We recommend that you allot at least 1U space above the server system to ensure optimal thermal performance.

### Removing the footpads

1. Lay the system chassis on its side.
2. Remove the footpad by rotating it counterclockwise with a Philips (cross) screwdriver.
3. Repeat steps 1 and 2 to remove the other three footpads.

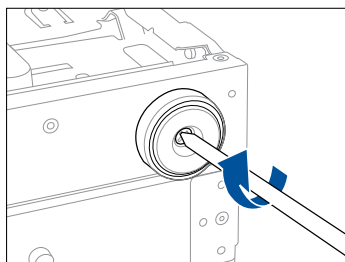

### Removing the top cover

Unscrew and slide the top cover toward the rear panel, and then lift it up from the chassis.

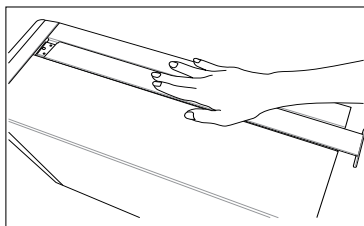

## 1.2 Attaching the inner rail to the server

1. Press the lock on side of the rail and slide the inner rail out from the rackmount rail kit.

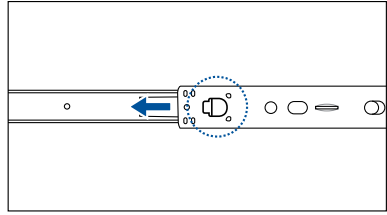

2. Slide the inner rail into the rail on top of the chassis.
3. Align the screw holes on the inner rail and the chassis top, and then secure the inner rail to the chassis top with screws.

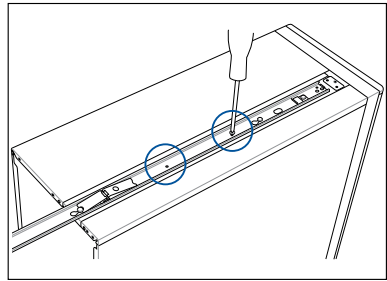

4. Repeat the previous steps to secure the other inner rail to the bottom of the chassis with screws.

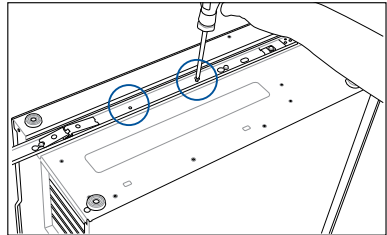

5. Use three screws to secure the side hooks to both rails.

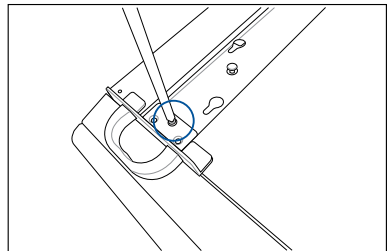

# 1.3 Attaching the rails to the rack

To attach the rails to the rack:

1. Select one unit of space (1U) on the rack where you wish to install the server.

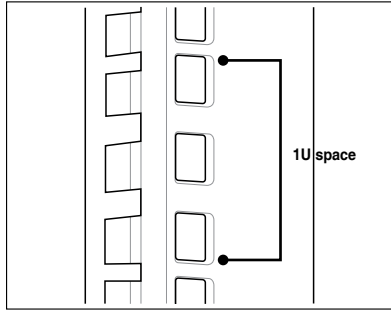

2. Drive in two screws on the rack rails.

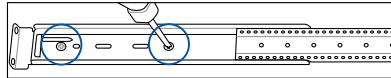

3. Align the front end holes of a rack rail pair to the 1U space.
4. Drive in two screws on the outer holes to secure the front end.

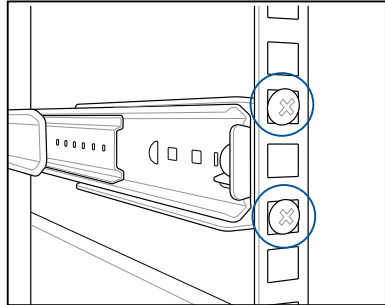

5. Find the rear 1U space that corresponds to the front 1U space where you attached the rail. Drive in two screws on the outer holes to secure the rear end.
6. From the rack front, find the corresponding 1U space for the second rail pair.
7. Repeat steps 3–6 to attach the second rail pair.

## 1.4 Mounting the server to the rack

To mount the server to the rack:

1. Align the server rails with the rack rails.
2. Press the lock on side of the rail and slide the server into the rack.

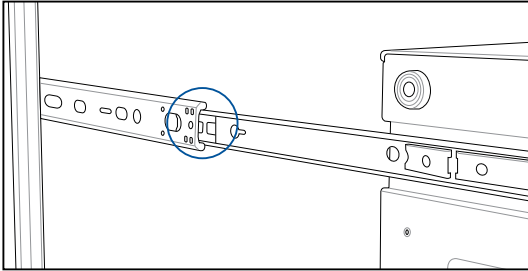

3. When the server is fully slide into the rack, secure both sides using screws.

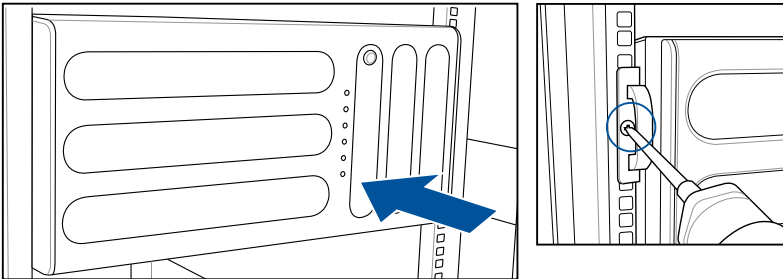

## 2. Rail kit dimensions

### Outer rail length (unit: mm; installed to the rack)

Minimum length when closed: 731 mm; maximum length: 850.5 mm

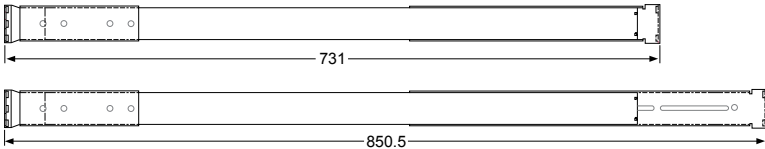

### Inner rail length (unit: mm; installed to the chassis)

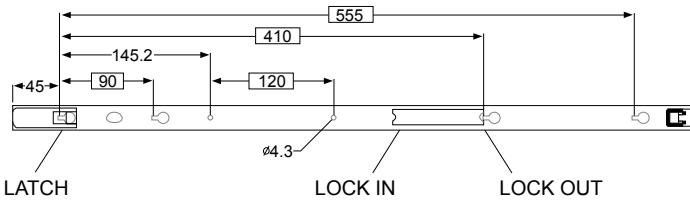

### Inner and outer rail assembly maximum length (unit: mm)

Total length:  $687.5 + 850.5 = 1538$  mm

